

A pocket Sliding Door System that optimises usage of space.. Since 1995

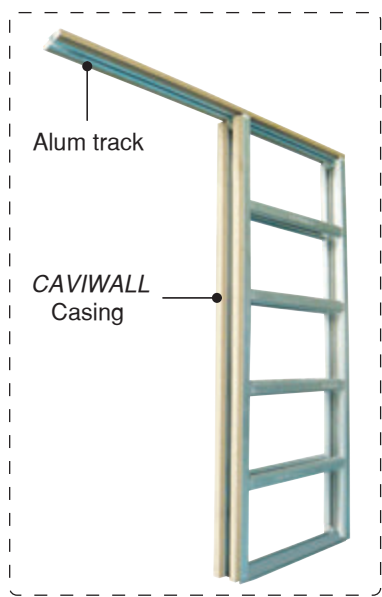

- ✓ **CAViWALL** increases the attractiveness of new housing development project to potential buyers and investors through offering a superior, thoughtful and spacious floor layout.
- ✓ **CAViWALL** transform wasted floor areas into usable space to allow homeowners more space for storage or to enhance their living environment.
- ✓ **CAViWALL** equipped Architects and Interior Designers with more flexible design options when they are faced with the challenge of delivering the best floor layout versus decreasing built-in floor area.

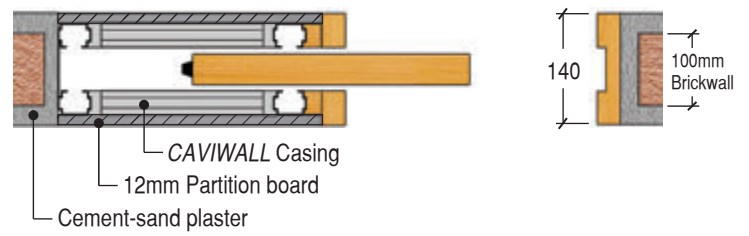

The package containing CAViWALL components is lightweight and easy to carry.

CAViWALL Components



COMPANY BACKGROUND

SLIDE & HIDE System (S) Pte Ltd was incorporated in Singapore in 1995 to manufacture and supply products that optimises usage of interior space. Over the years, our brand "**SLIDEHIDE**" and "**CAVIWALL**" had been well accepted by the real estate industry as a top-quality concealed sliding door system.

Until today, our systems had been installed in Singapore, Malaysia, China, Japan, Dubai, Vietnam, Sri Lanka and other Asian countries.

To stay relevant now and in future, we fervently seek to work closely with developers, architects, designers and constructors to better understand their aspiration and needs. This interaction and networking also provide the opportunity to spot new trends and learn new concepts.

Our Strength

We have more than 20 years of experience, from R&D to manufacturing of concealed sliding door systems and related space saving products.

Our Mission

Our goal is to deliver top quality space-optimization products so that people will have more indoor space to live, work and enjoy their activities.

Our Vision

We want to be Asia's leading Corporation in delivering creative, top quality, competitive and reliable products. To retain our position, we strive to constantly innovate, stay productive and maintain high quality standard.

OUR PRESENCE

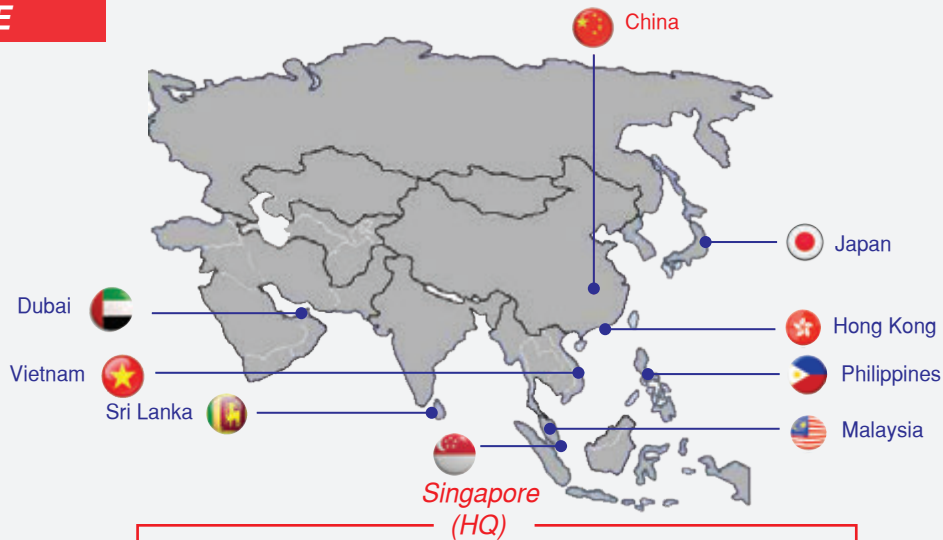

PRODUCTION AREA



SINGAPORE WORKFORCE

PROJECT REFERENCES

SOME OF THE PRESTIGIOUS PROJECTS COMPLETED :-

SINGAPORE



Ardmore Park Condo



St Regis Residences



Reflections at Keppel Bay



Cliveden at Grange



D' Leedon Condominium



Lush Acres Executive Condo



The Oceanfront @ Sentosa Cove



Changi General Hospital



W Hotel Sentosa



Shangri-La Hotel



South Beach Residences



Sky Terrace @ Dawson (HDB BTO)

OVERSEAS PROJECTS

CHINA



Four Seasons Garden (Shanghai)



Marriott Hotel (Shanghai)



Sheraton Hotel (Beijing)



Crowne Plaza Service Apartments (Suzhou)



Minya Hotel (Chengdu)



Hua Yuan Qiumadu (Beijing)

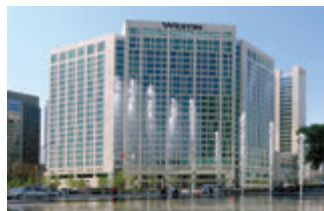

Westin Hotel (Beijing)



Xuhui Yuyuan (Shanghai)



*L' Hotel
(Hong Kong)*



*Park Eleven
(Shanghai)*



*Four Seasons Hotel
(Hong Kong)*



*W Hotel
(Shanghai)*

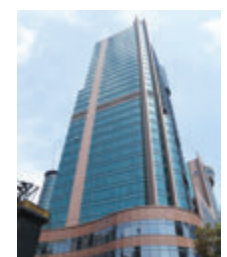

*Wanbao International Plaza
(Shanghai)*

PROJECT REFERENCES

OVERSEAS PROJECTS

MALAYSIA



Seri Pilmoor Bungalows



Damansara City



Ritz Carlton Residences



Somerset Puteri Harbour



Setia Sky Residences



The Light Collection I



M Suites



Pavilion Residences



Setia V Residences



Madge Mansions



Park Seven



The Light Collection IV

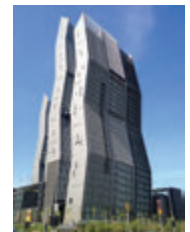

The Capers

VIETNAM, Ho Chi Minh City



Nam Khang Apartment



Panorama Apartments

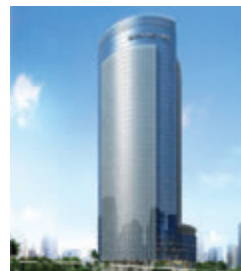

M&C Tower



Rex Hotel

OTHER COUNTRIES



*The Dubai Mall
(Dubai, United Arab Emirates)*



*Emperor Hotel
(Colombo, Sri Lanka)*

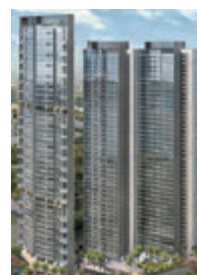

*Anandamaya Residences
(Jakarta, Indonesia)*



*Daiwahouse-Retirement Home
(Tokyo, Japan)*

WHAT IS "CAVIWALL"

CAVIWALL is a pre-fabricated skeletal casing that is delivered in an easy to carry DIY package. The assembly of the cavity casing can be executed inside or outside the construction site. **CAVIWALL** is user-friendly, lightweight, reliable, easy and fast to install by any tradesman.

Flat and habitable land is precious in many cities of large countries. As a result, land price keeps on increasing, leading to shrinkage of living space. Hence, optimisation of live-in area and interior layout is the objective of every developer, architect and homeowner. Coupled with shortage of skilled workers, productivity must be raised without sacrificing quality finishes.

Being aware of tight space problem, demand for higher productivity, wanting full control of construction cost and high quality finishes, we designed and developed a new product called **CAVIWALL**, to deliver the solution.

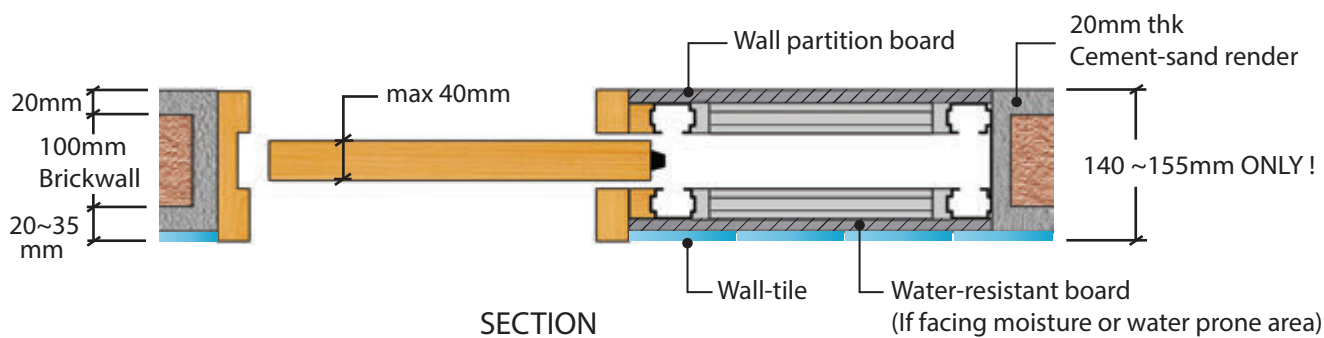
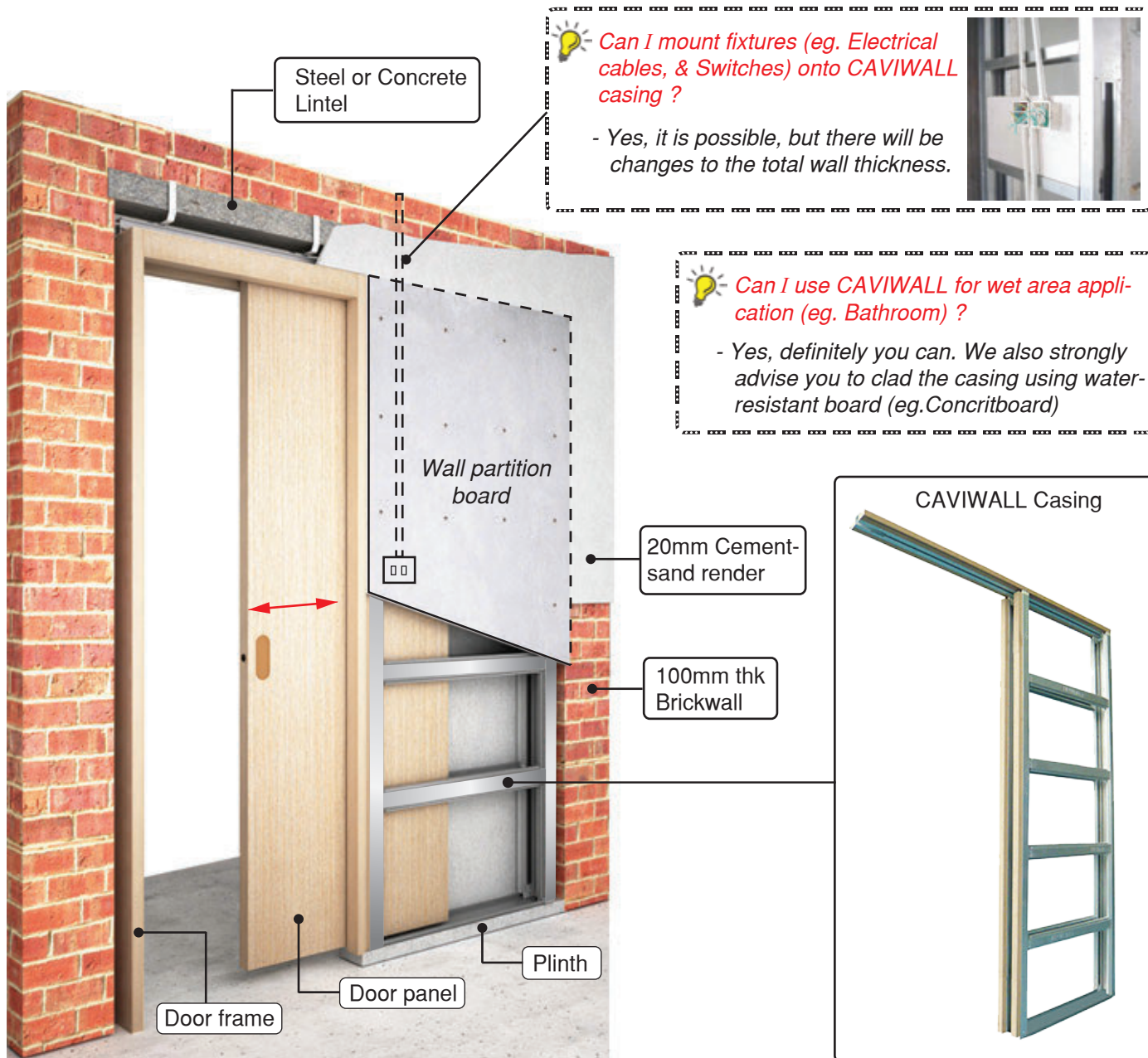

FLAWS OF TRADITIONAL DOORS

FLAWS OF SWING DOOR

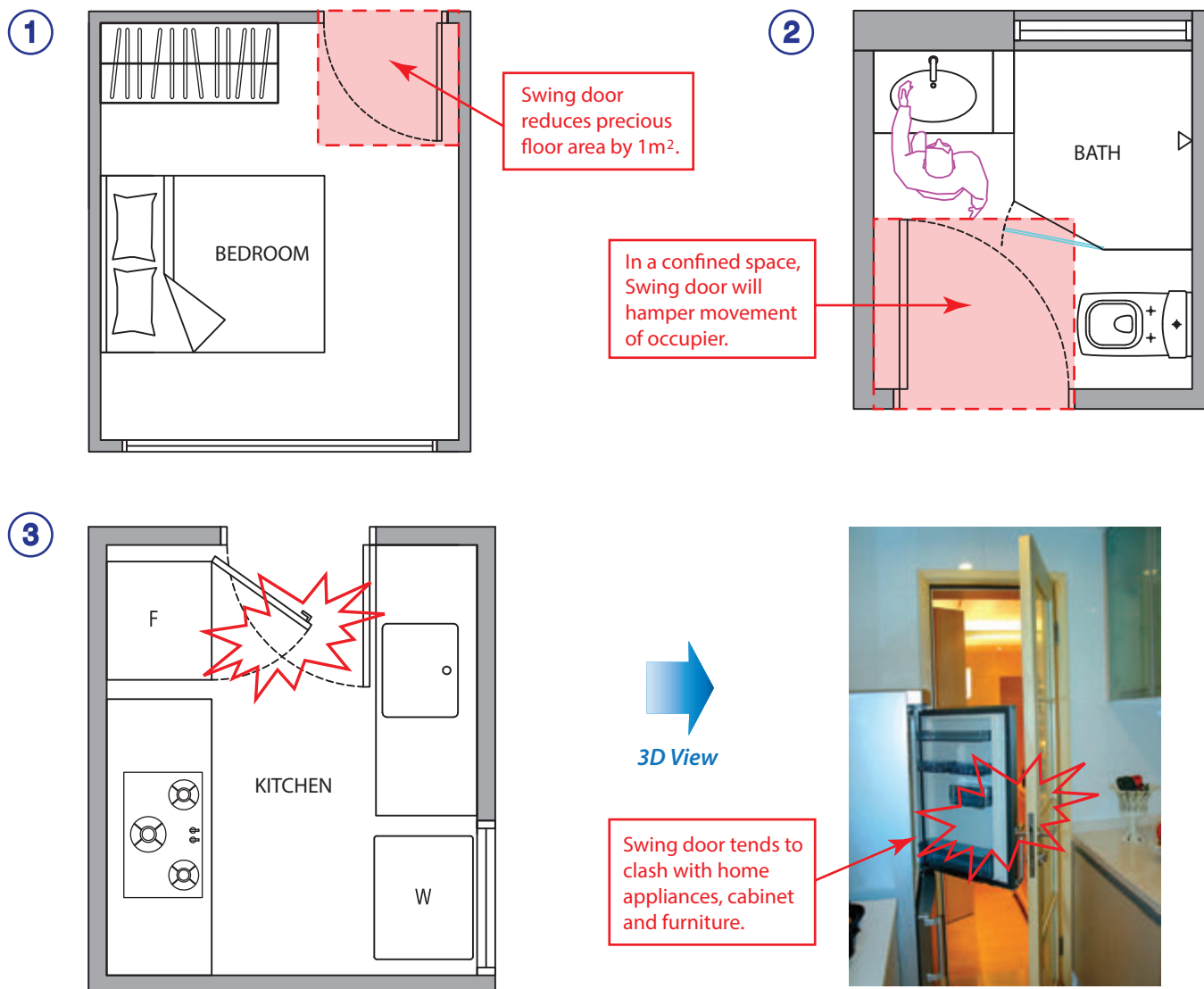

FLAWS OF EXPOSED SLIDING DOOR

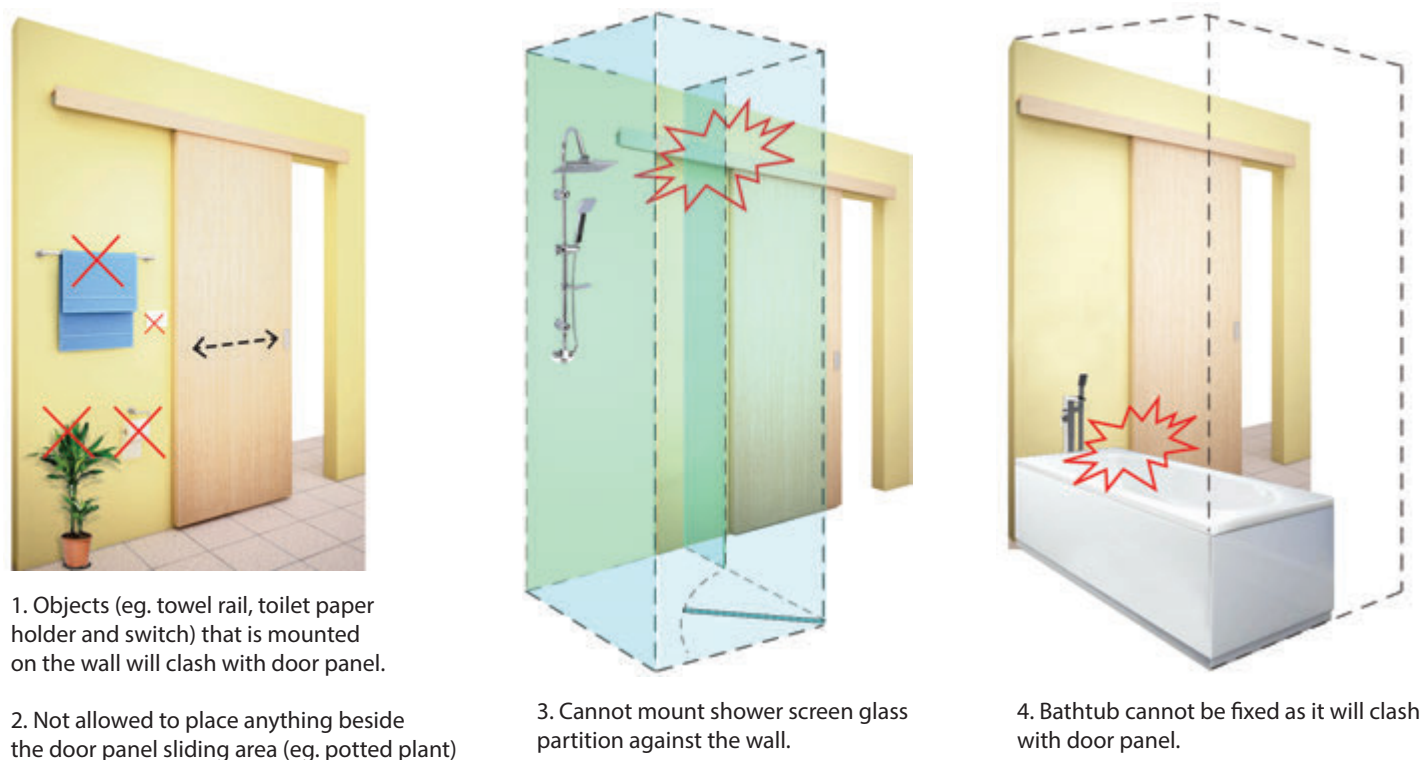

BENEFITS OF CAVIWALL

A FUNCTIONAL VERSUS A THOUGHTFUL DESIGN

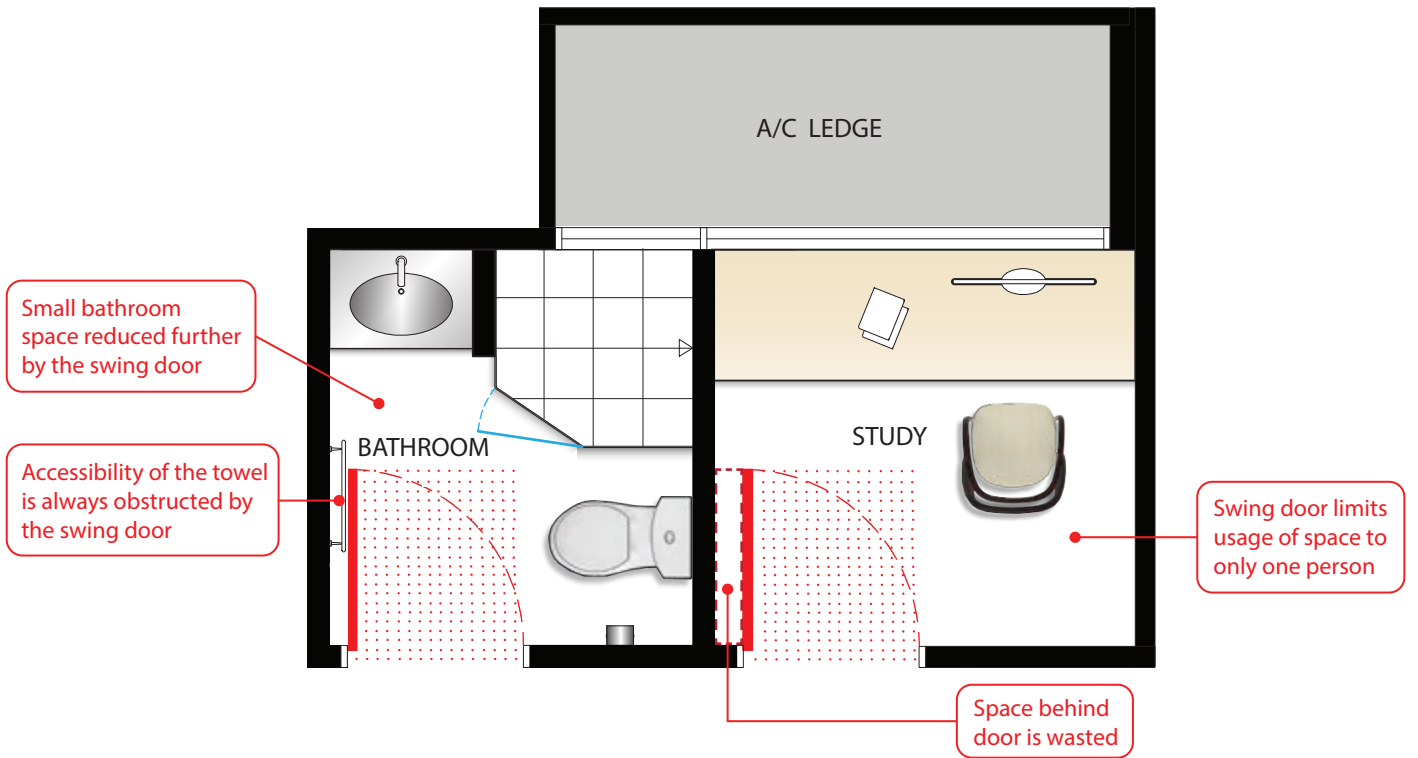

BEFORE

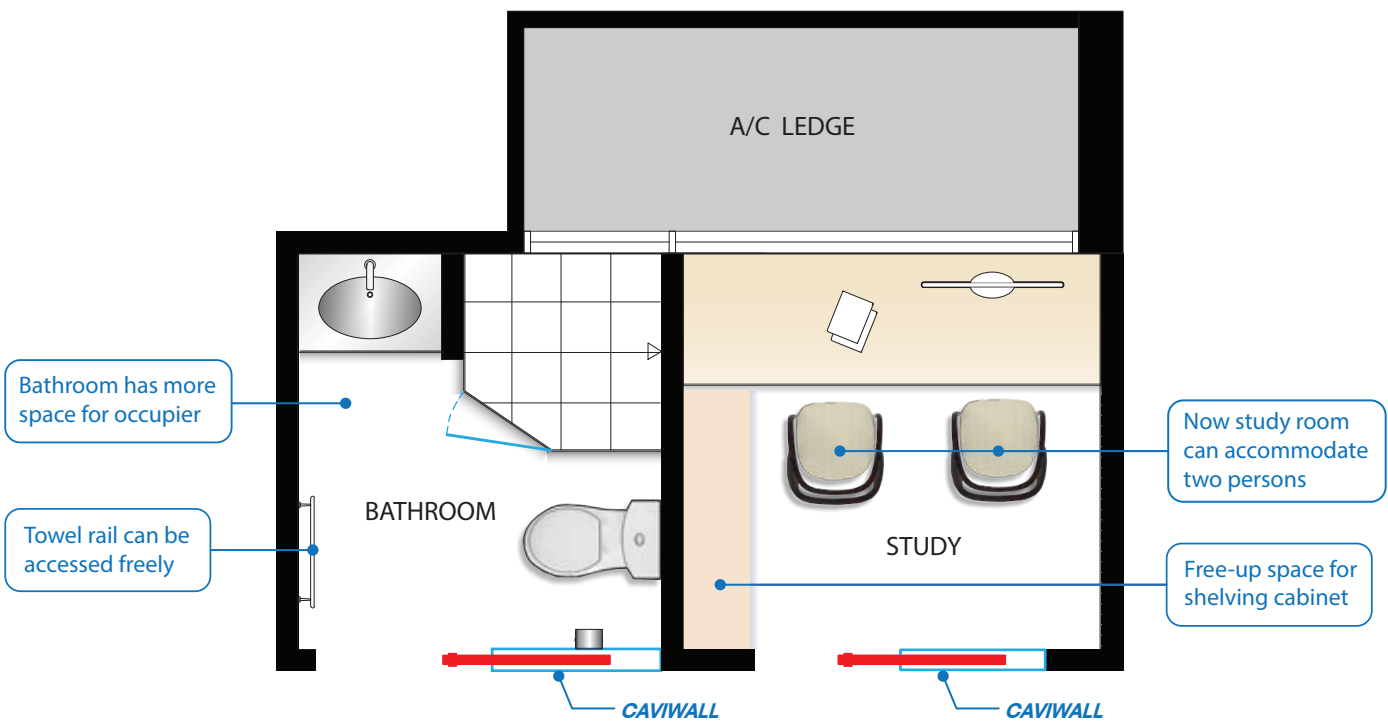

AFTER

BENEFITS OF CAVIWALL

TRANSFORMING WASTED SPACE TO USABLE SPACE

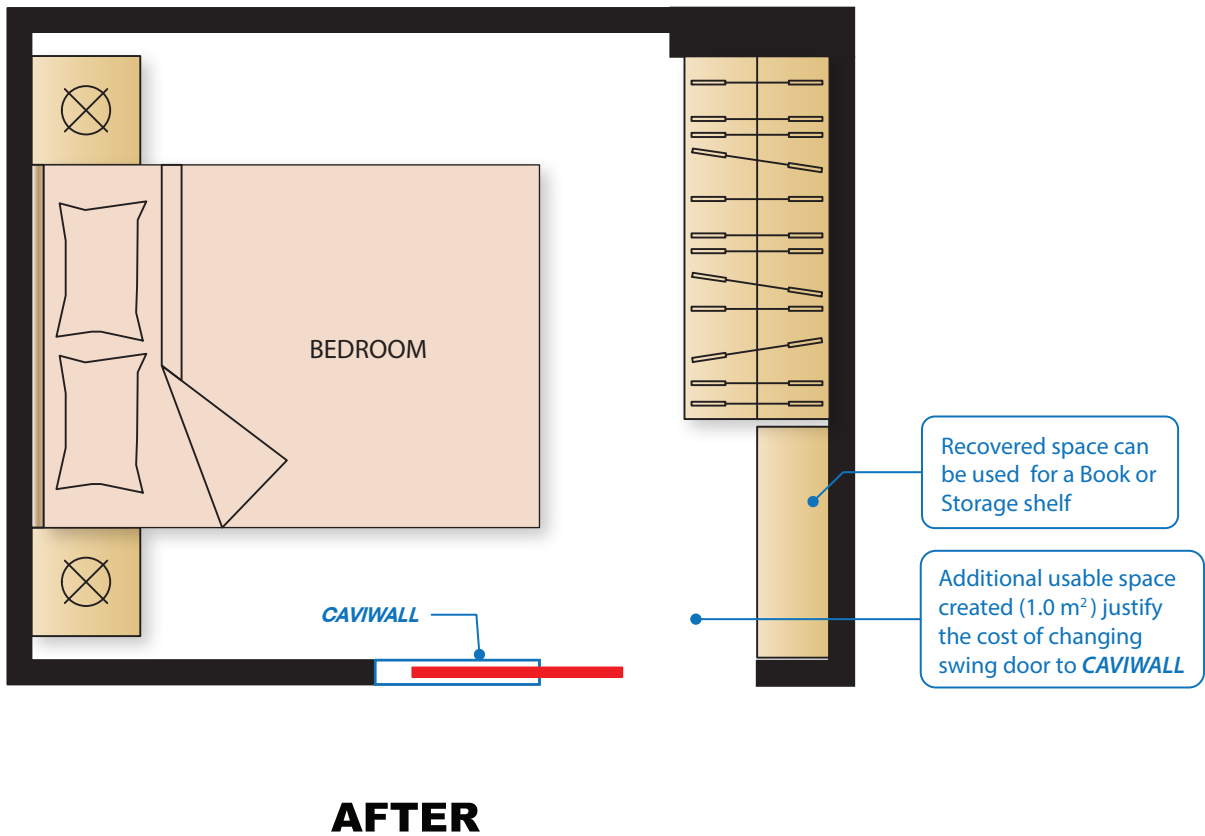
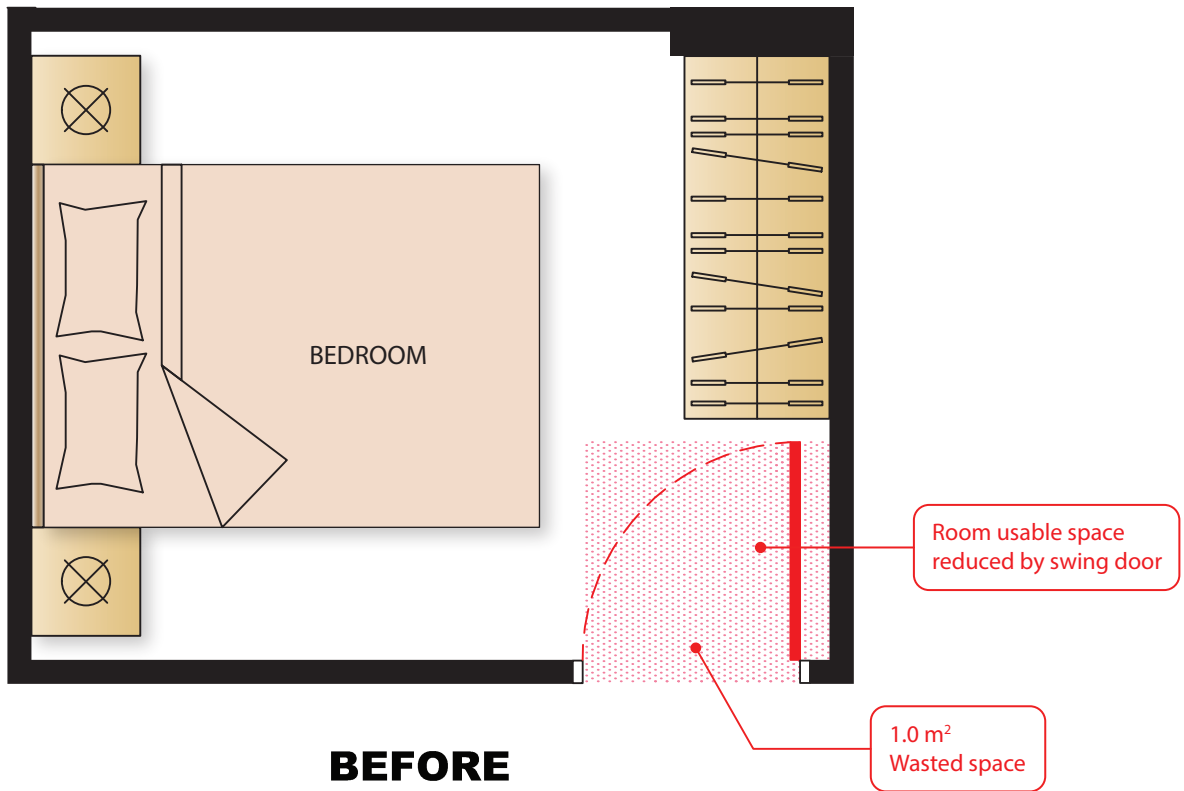

BENEFITS OF CAVIWALL

CREATING MORE SPACE FOR A 36m², 1-BEDROOM CONDOMINIUM

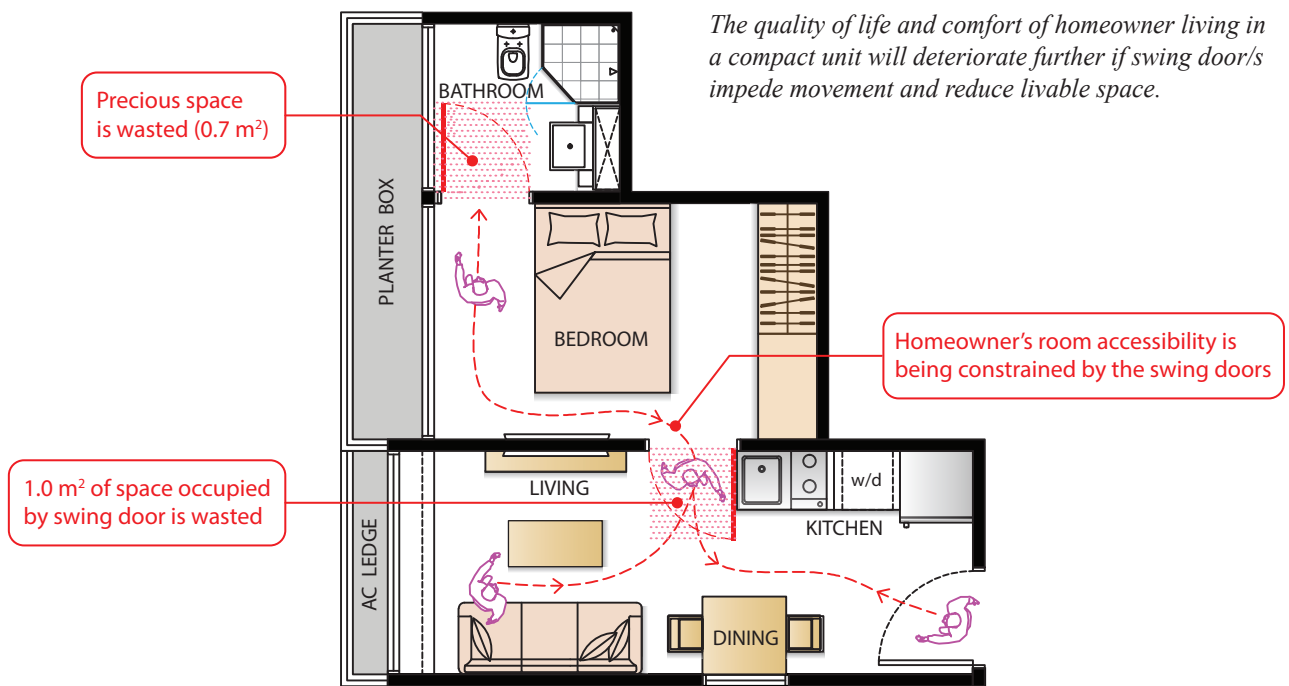

BEFORE

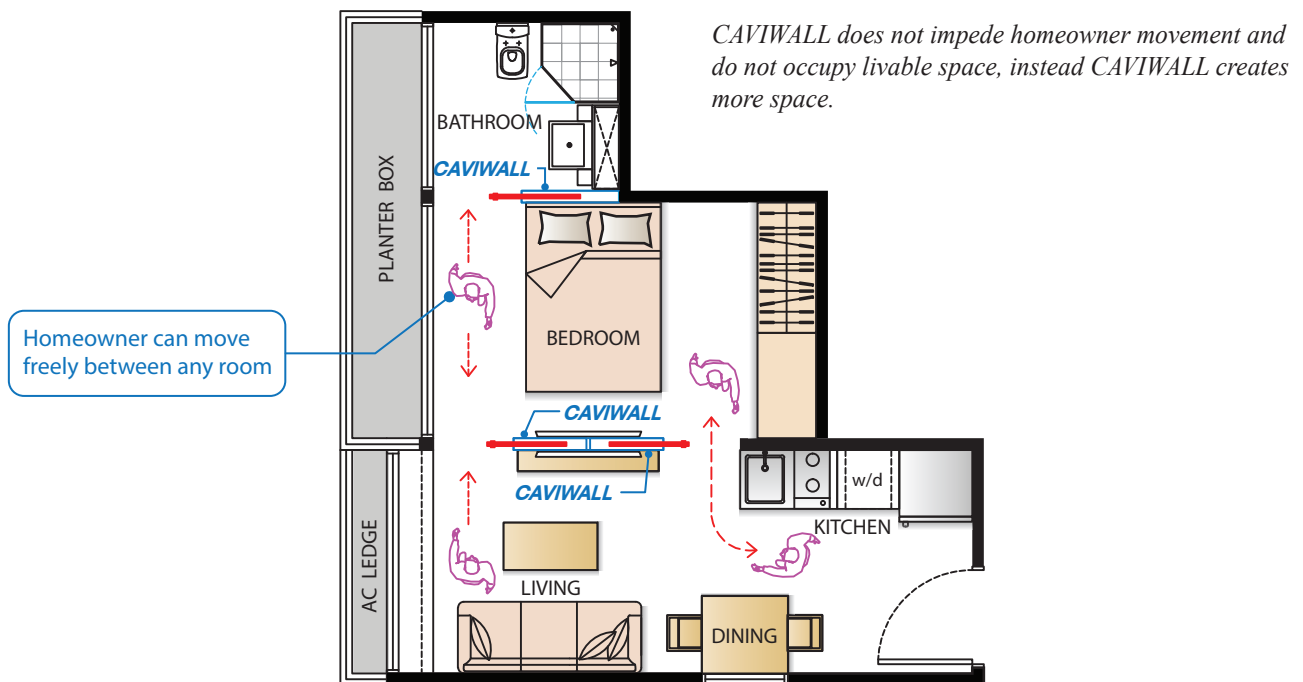

AFTER

BENEFITS OF CAVIWALL

CONVERTING DEMARCATED AND CONFINED SPACES INTO A CONNECTED AND BIGGER OPEN SPACE

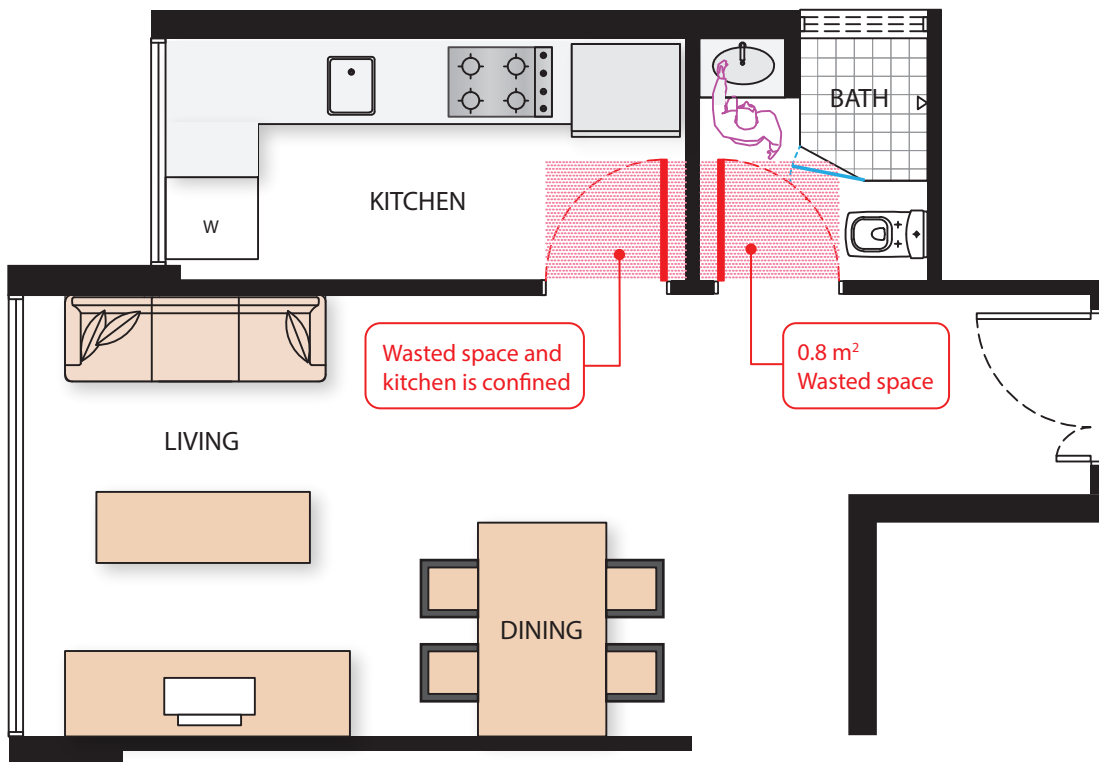

BEFORE

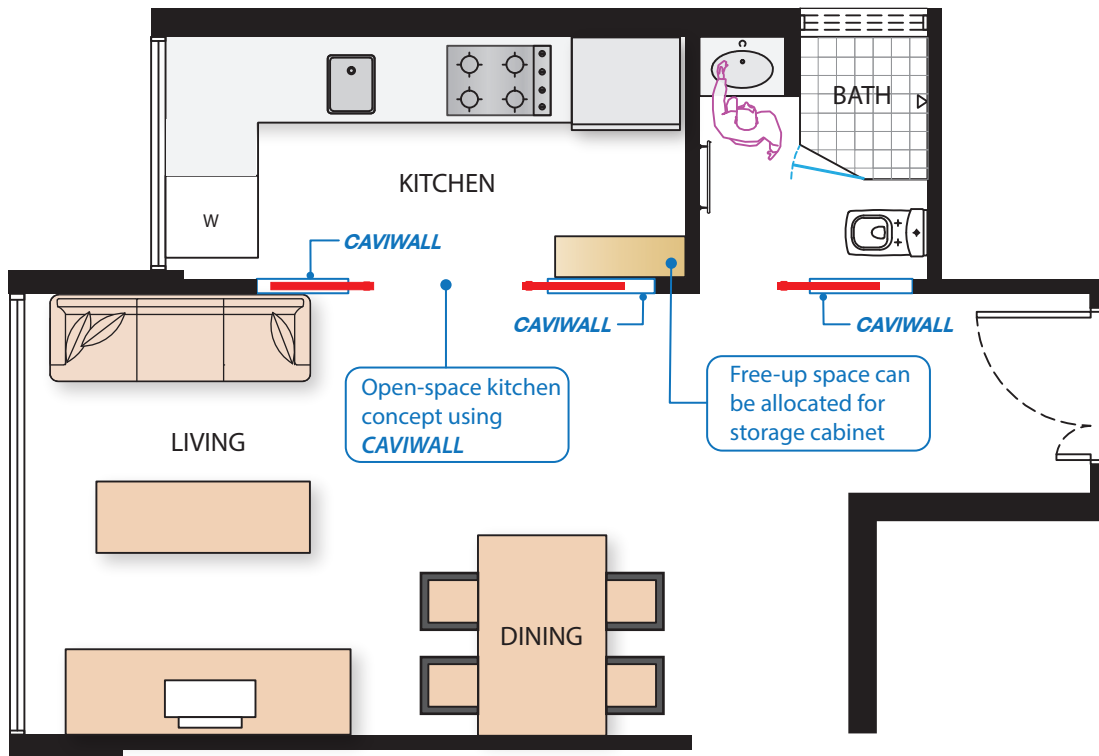

AFTER

BENEFITS OF CAVIWALL

IMPROVING PRODUCTIVITY AND PROTECTING PATIENT'S PRIVACY IN A HOSPITAL

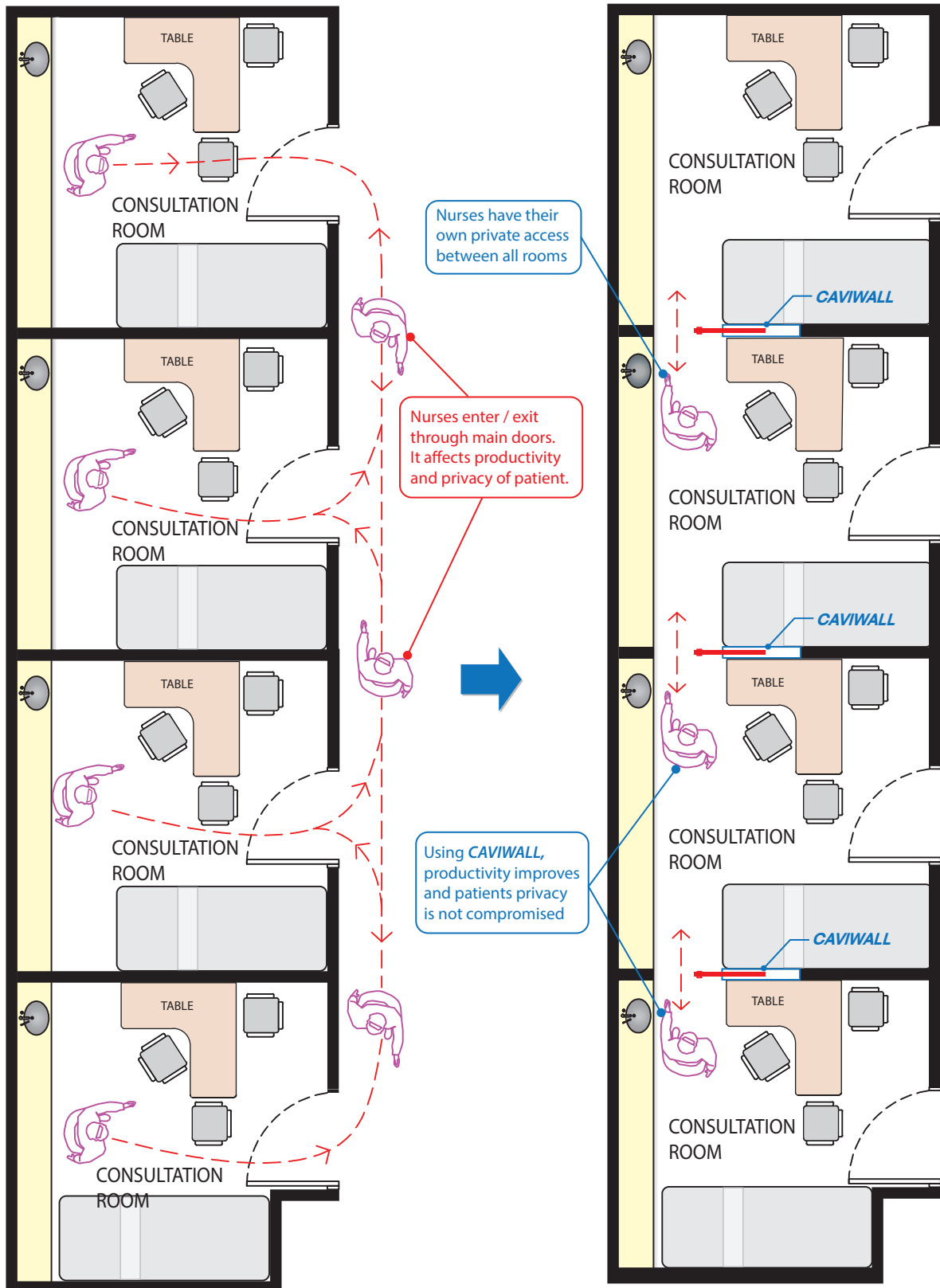

BEFORE

AFTER

UNIQUENESS OF CAVIWALL

✓ **Lightweight & Easy to carry.**



✓ **Easy to Store & Transport over long distances.**



✓ **Easy Assembly & Fast Installation.**



Requires only 1 tradesman to assemble and install.

✓ **User-Friendly & Customizable.**



If Lintel or wall opening is discovered to be lower or smaller than pre-arranged dimensions, the sliding track and casing-steel studs can be cut on-site to suit new dimensions.

✓ **Recyclable**

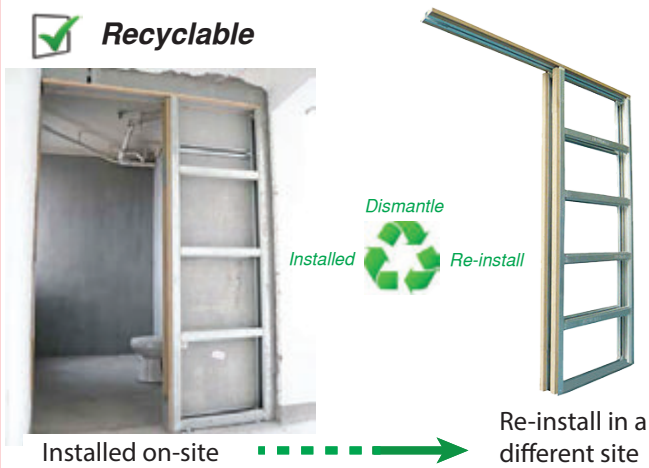

✓ **Rugged Product**



✓ **Economical & Good Quality.**



✓ **Dimension & Accuracy is Assured.**

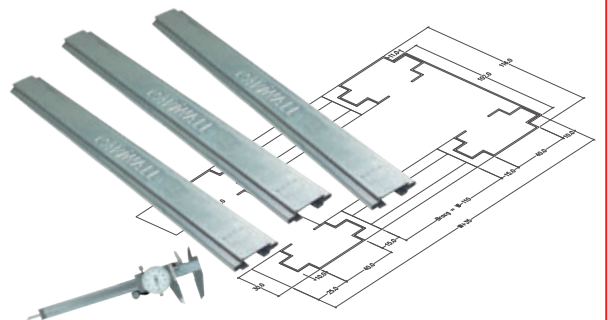

CAVIWALL ASSEMBLY GUIDE

1. Unpack CAVIWALL casing for assembly.

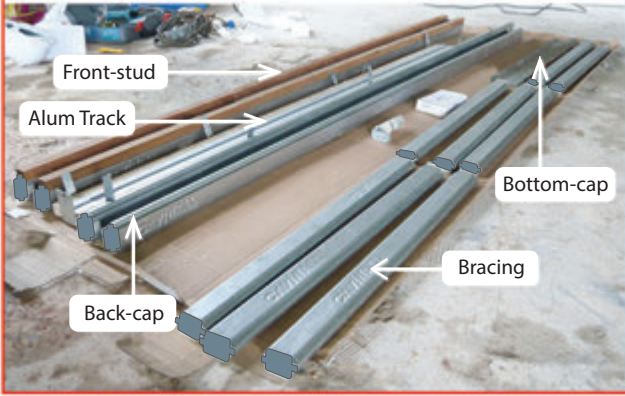

2a. Place Front-stud, Back-cap and Bottom-cap in position.

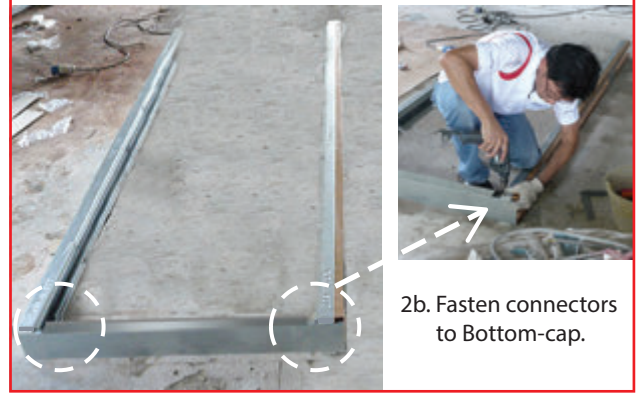

3. Mark position for bracings, spacing them equally.

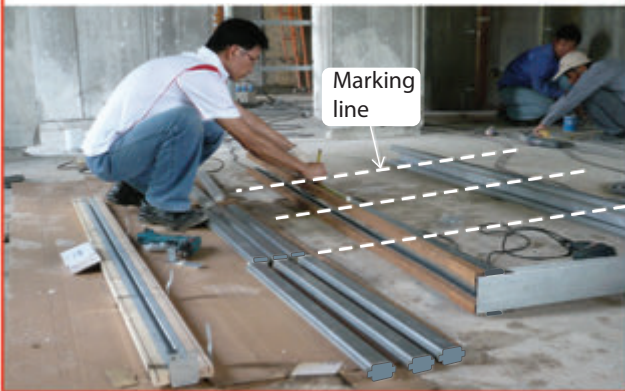

4. Position bracing to the marked line, then fasten connector to Front-stud and Back-cap.



5. Flip over half-completed CAVIWALL casing to fix balance bracings and components.



6. Repeat step 2b, 3 and 4.



7a. Place Aluminium track onto Front-stud and Back-cap.



8. Assembled CAVIWALL casing is ready for installation onto structural wall.



 How long does it take to assemble a CAVIWALL casing ?
- 1 skilled worker can assemble it within 20 mins .

CAVIWALL SCOPE OF WORKS

1. Standby proposed structural wall opening, overhead lintel and plinth (optional).



2. Prepare CAVIWALL casing for installation.



3. Anchor the CAVIWALL casing within the structural opening. The gaps between the track / casing and brickwall will be grouted with cement-sand.



4. Clad CAVIWALL casing with partition board. Trowel cement-sand plaster onto brickwall. Lay fibremesh along plaster/partition board interface to minimize plaster cracks.



5. After floor and wall finishes is completed, standby to fix door frame and door panel.



6. Installation sequence is completed.



 How many casings can be installed in one day? - 1 skilled worker can install 5 to 6 casings per day.

DOOR PANEL+ FRAME, ACCESSORIES INSTALLATION GUIDE

Fix Accessories to Door Panel

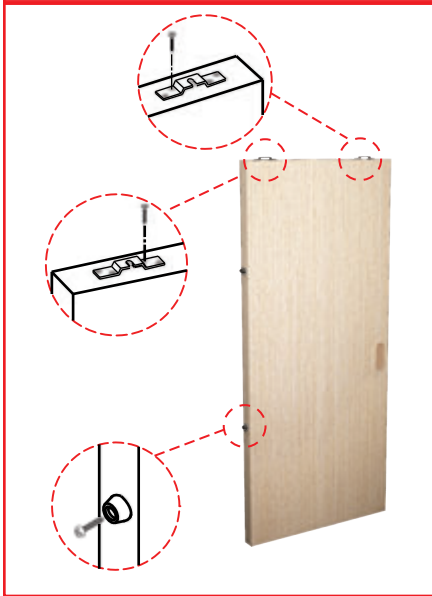

Fix Door Frame using adhesive or fastener



CAVIWALL Standard Accessories



Roller & Hanging bracket



Glass clamp

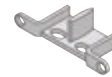

Door-guide



Anti-impact stopper



Step 1 - Fix Accessories to Door panel

Step 2 - Hang Door panel

Step 3 - Fix Door frame

Step 4 - Fix Door-guide

What if in future the homeowner wants to replace the door panel ?

- Procedure :
1. Remove the door-guide.
 2. Remove top door frame.
 3. Unlock the roller from the hanging bracket.
 4. Pull-out the door panel.

NO HACKING OF WALL IS REQUIRED !

PROBLEMS OF BUILT-ON-SITE SYSTEM

1. TRACK SAGS

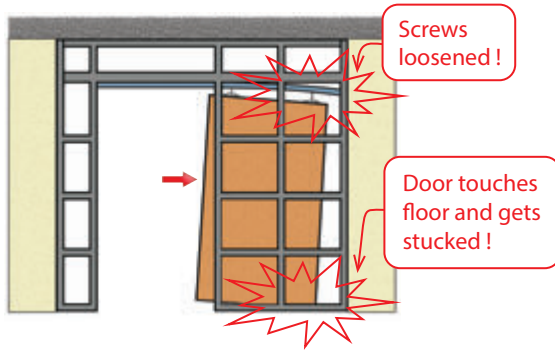

2. TRACK IS NOT HORIZONTAL

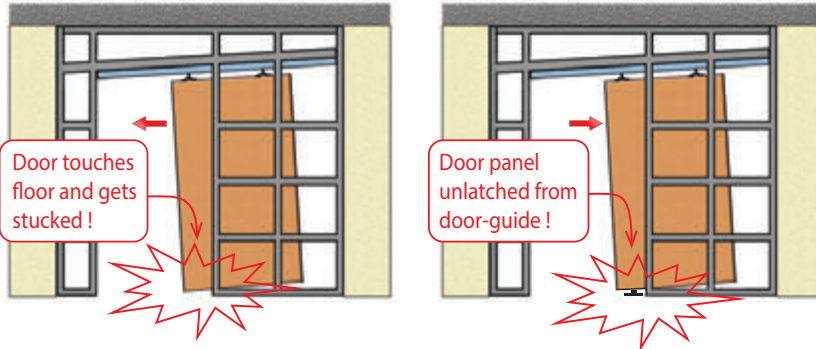

5. SUB-STANDARD WORKMANSHIP

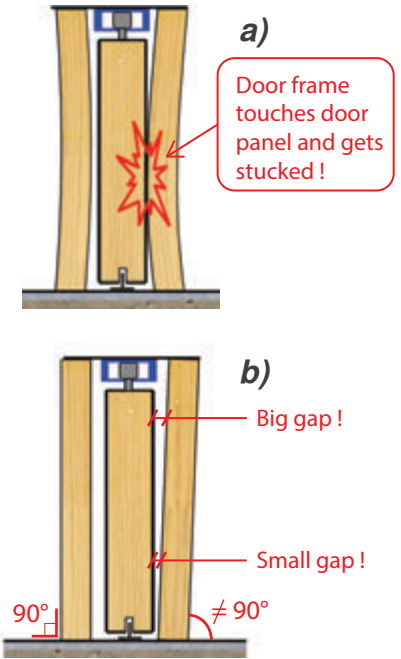

3. TRACK IS NOT IN THE CENTER OF POCKET WALL

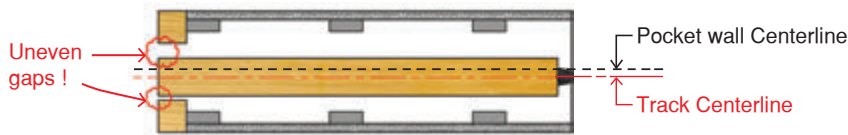

4. TRACK IS NOT PARALLEL TO THE CENTERLINE OF POCKET WALL

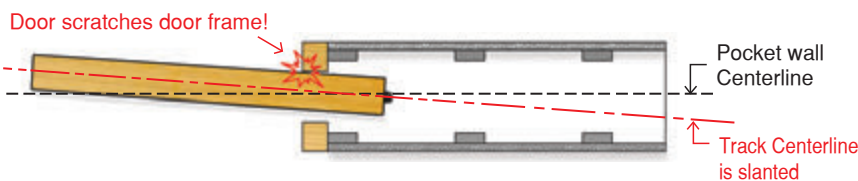

6. VERY THICK AND UGLY POCKET WALL

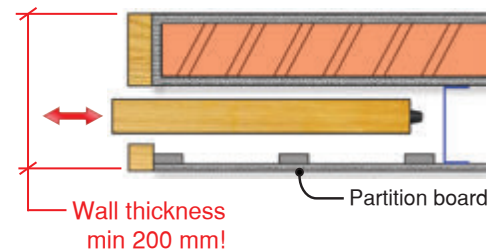

OTHER RELATED ISSUES

- * If welding of steel hollow section is the preferred method to construct a pocket-wall frame, there will be a risk of explosion.
- * The time required to construct a Built-On-Site pocket wall frame system of acceptable quality is unproductive...approx 1~2 sets per day.
- * Stoppage of work if some vendors fail to deliver materials on time to jobsite.
- * Built-On-Site System do not have quality assurance.
- * Unreliable Rollers quality.

CAVIWALL

"Optimising Space Usage"



CAVIWALL QUALITY ASSURANCE

CAVIWALL Rollers Endurance test result.

No audible sound heard and no shaky sliding motion felt after 100,000 cycles.
One cycle is equal to back and forth motion.

CAVIWALL MODELS

CAVIWALL OFFERS 6 DIFFERENT DESIGNS TO SATISFY DESIGNERS CREATIVE MIND



1D1B (1 DOOR in 1 BOX)



2D2B (2 DOORS in 2 BOX)



1D1B-F (1 DOOR in 1 BOX - Frameless glass door)



2D2B-F (2 DOORS in 2 BOX - Frameless glass door)

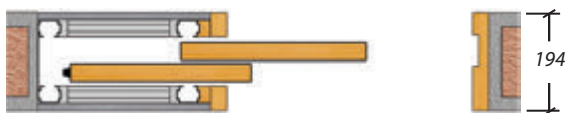

2D1B (2 DOORS in 1 BOX)



4D2B (4 DOORS in 2 BOX)

CAVIWALL SPECIFICATION



1D1B (1 DOOR in 1 BOX)					
CLEAR DOOR WIDTH, W (mm)	CLEAR DOOR HT, H (mm)	STRUCT OPENING S.O. (mm)	LINTEL HT, L (mm)	DOOR PANEL	
				WIDTH (mm)	HEIGHT (mm)
700	H = 1900 to 3000mm in increment of 50mm	1500	L = Track soffit ht (T) + 55mm measured from FINISHED FLOOR	Door Panel Width = W + 20mm	Door Panel Ht = Track soffit ht (T) - 25 - 10 (Floor gap)
800		1700			
900		1900			
1000		2100			
1100		2300			
1200		2500			

LEGEND :-

S.O. - Structural wall opening width.
W - Clear door width.

T - Height from Finish Floor Level (FFL) to Track soffit.
L - Height from Finish Floor Level (FFL) to Lintel soffit.
H - Height from Finish Floor Level (FFL) to top door frame soffit.

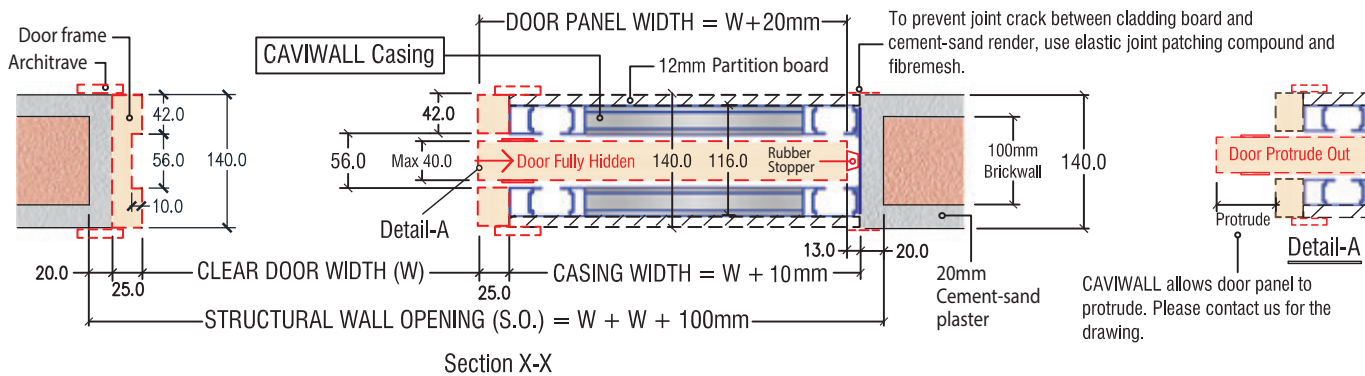
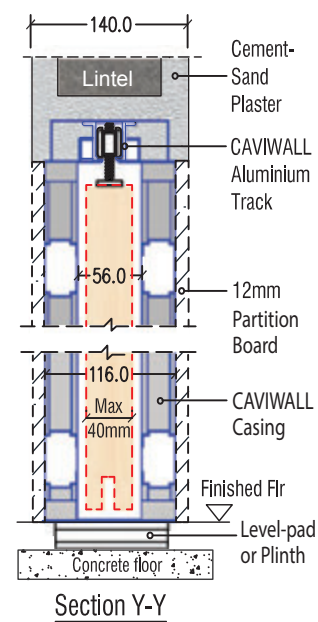
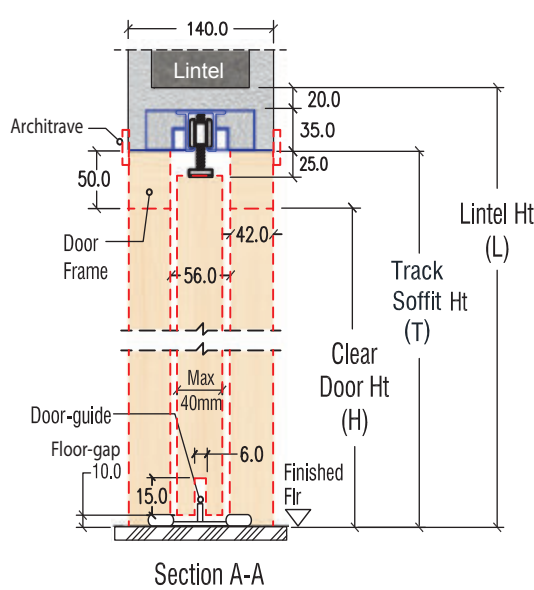
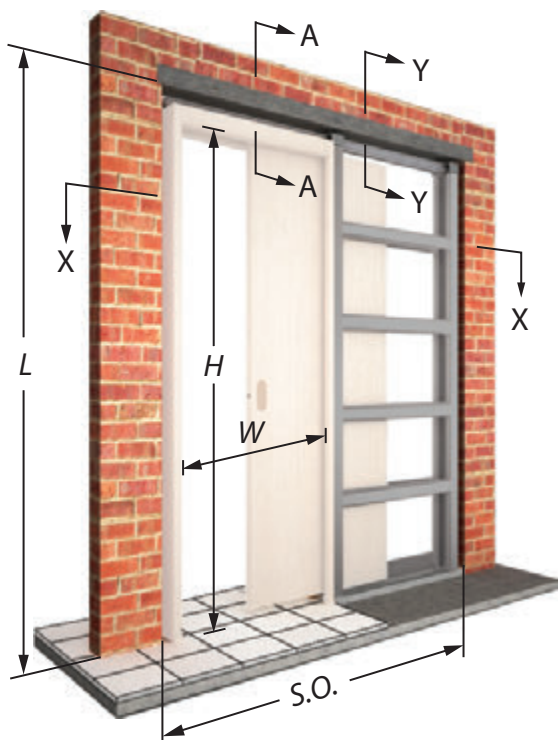

MATERIAL DESCRIPTION AND SPECIFICATION

Provide proprietary "CAVIWALL" cavity wall system for clear door opening $W \times H$, comprising a factory pre-fabricated steel casing formed from connecting profiled steel studs, self-supported min 35mm Aluminium Track/s c/w side supports, upto 120kg capacity Rollers and sliding door accessories. Rollers must passed the 100,000 cycles Endurance Test by a government accredited testing center.

STANDARD ACCESSORIES



SLIDE & HIDE System (Suzhou) Co Ltd
Tel : +86-512-6593 0005
Fax : +86-512-6593 0006
Email : enquiry@slidehide.com.sg
Website : www.slidehide.com.sg

SLIDE & HIDE System (Singapore) Pte Ltd
Tel : +65-6369 9988
Fax : +65-6369 9977
Email : enquiry@slidehide.com.sg
Website : www.slidehide.com.sg

CAVIWALL SPECIFICATION



2D2B (2 DOORS in 2 BOX)					
CLEAR DOOR WIDTH, W (mm)	CLEAR DOOR HT, H (mm)	STRUCT OPENING S.O. (mm)	LINTEL HT, L (mm)	DOOR PANEL	
				WIDTH (mm)	HEIGHT (mm)
1400	H = 1900 to 3000mm in increment of 50mm	2910	L = Track soffit ht (T) + 55mm measured from FINISHED FLOOR	Door Panel Width = 0.5 W + 20mm	Door Panel Ht = Track soffit ht (T) - 25 - 10 (Floor gap)
1600		3310			
1800		3710			
2000		4110			
2200		4510			
2400		4910			

LEGEND :-

S.O. - Structural wall opening width.
W - Clear door width.

T - Height from Finish Floor Level (FFL) to Track soffit.
L - Height from Finish Floor Level (FFL) to Lintel soffit.
H - Height from Finish Floor Level (FFL) to top door frame soffit.

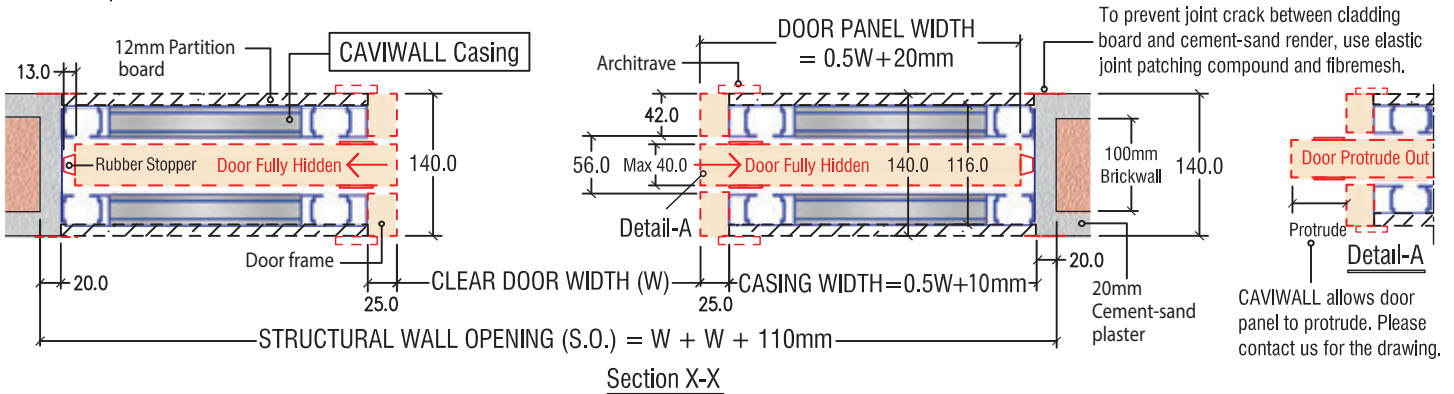
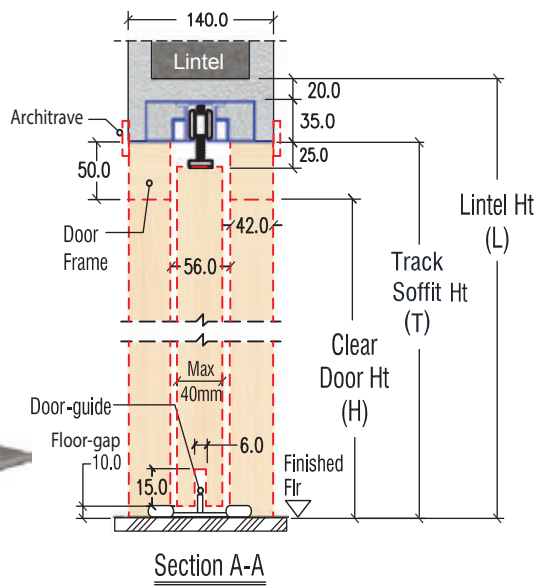
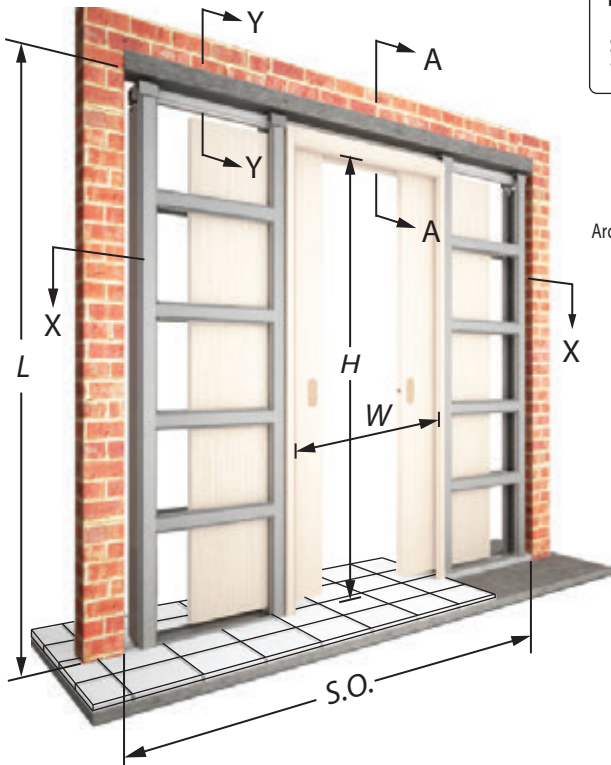

MATERIAL DESCRIPTION AND SPECIFICATION

Provide proprietary "CAVIWALL" cavity wall system for clear door opening $W \times H$, comprising a factory pre-fabricated steel casing formed from connecting profiled steel studs, self-supported min 35mm Aluminium Track/s c/w side supports, upto 120kg capacity Rollers and sliding door accessories. Rollers must passed the 100,000 cycles Endurance Test by a government accredited testing center.

STANDARD ACCESSORIES

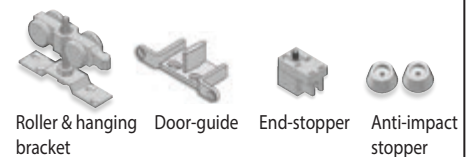

SLIDE & HIDE System (Suzhou) Co Ltd

Tel : +86-512-6593 0005
Fax : +86-512-6593 0006
Email : enquiry@slidehide.com.sg
Website : www.slidehide.com.sg

SLIDE & HIDE System (Singapore) Pte Ltd

Tel : +65-6369 9988
Fax : +65-6369 9977
Email : enquiry@slidehide.com.sg
Website : www.slidehide.com.sg

CAVIWALL SPECIFICATION



1D1B-F (1 DOOR in 1 BOX- Frameless glass door)					
CLEAR DOOR WIDTH, W (mm)	CLEAR DOOR HT, H (mm)	STRUCT OPENING S.O. (mm)	LINTEL HT, L (mm)	DOOR PANEL	
				WIDTH (mm)	HEIGHT (mm)
700	H = 1900 to 3000mm in increment of 50mm	1420	L = Track soffit ht (T) + 55mm measured from FINISHED FLOOR	Door Panel Width = W + 20mm	Door Panel Ht = Track soffit ht (T) - 40 - 10(Floor gap)
800		1620			
900		1820			
1000		2020			
1100		2220			
1200		2420			

LEGEND :-

S.O. - Structural wall opening width.
W - Clear door width.

T - Height from Finish Floor Level (FFL) to Track soffit.
L - Height from Finish Floor Level (FFL) to Lintel soffit.
H - Height from Finish Floor Level (FFL) to Pelmet soffit.

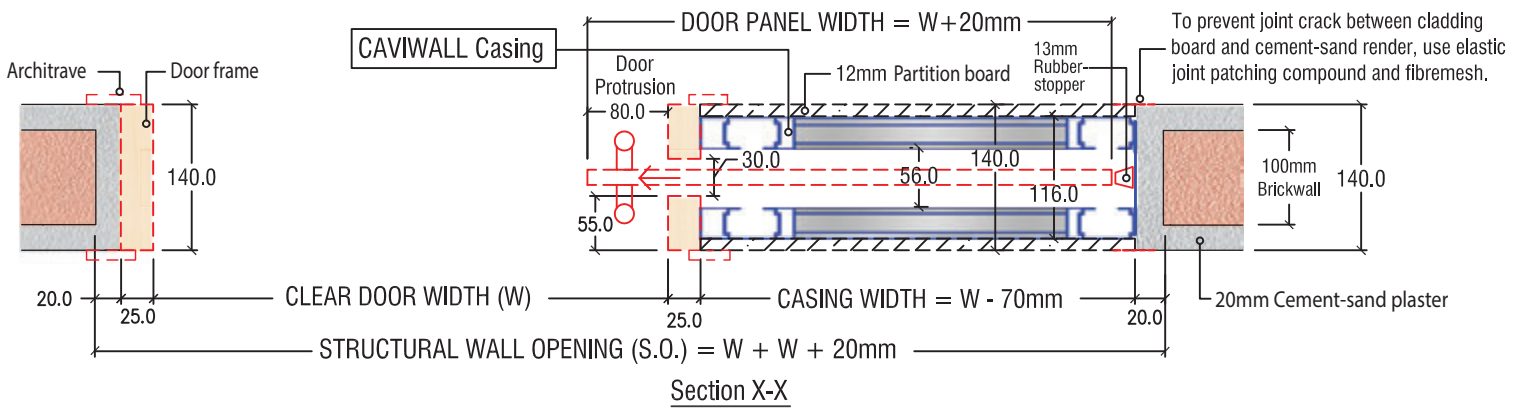
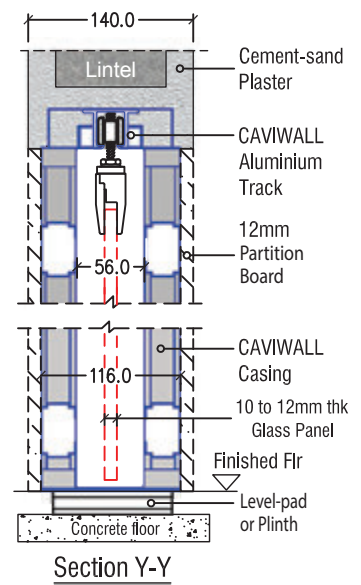
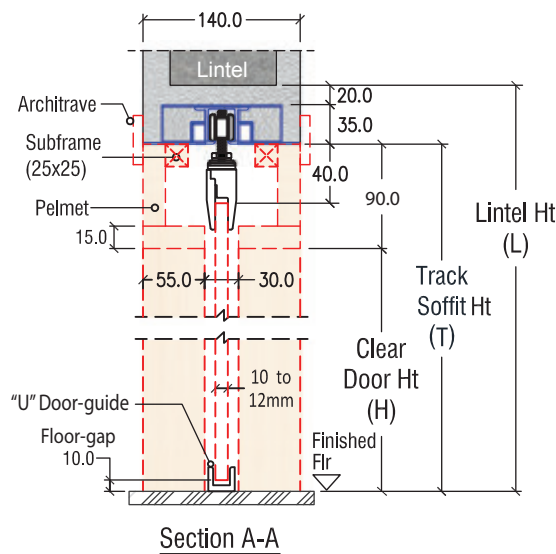
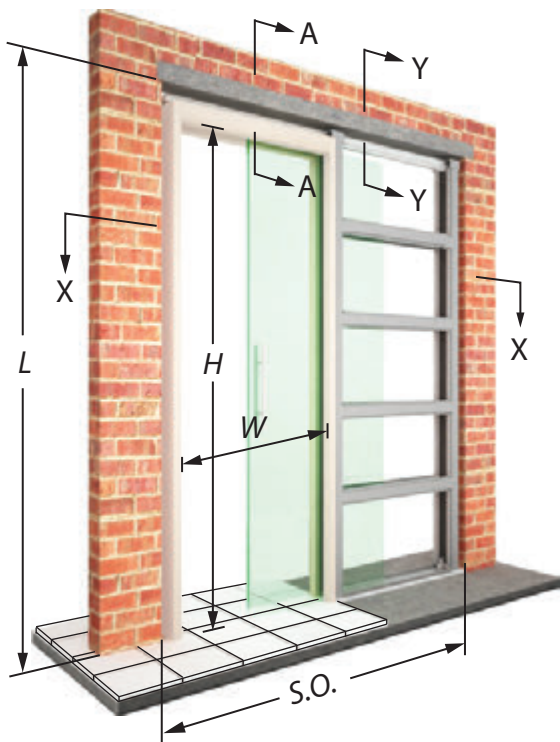

MATERIAL DESCRIPTION AND SPECIFICATION

Provide proprietary "CAVIWALL" cavity wall system for clear door opening W x H, comprising a factory pre-fabricated steel casing formed from connecting profiled steel studs, self-supported min 35mm Aluminium Track/s c/w side supports, upto 120kg capacity Rollers, Glass door aluminium clamps and sliding door accessories. Rollers must passed the 100,000 cycles Endurance Test by a government accredited testing center.

STANDARD ACCESSORIES



SLIDE & HIDE System (Suzhou) Co Ltd
Tel : +86-512-6593 0005
Fax : +86-512-6593 0006
Email : enquiry@slidehide.com.sg
Website : www.slidehide.com.sg

SLIDE & HIDE System (Singapore) Pte Ltd
Tel : +65-6369 9988
Fax : +65-6369 9977
Email : enquiry@slidehide.com.sg
Website : www.slidehide.com.sg

CAVIWALL SPECIFICATION



2D2B-F (2 DOORS in 2 BOX - Frameless glass door)					
CLEAR DOOR WIDTH, W (mm)	CLEAR DOOR HT, H (mm)	STRUCT OPENING S.O. (mm)	LINTEL HT, L (mm)	DOOR PANEL	
				WIDTH (mm)	HEIGHT (mm)
1400	H = 1900 to 3000mm in increment of 50mm	2750	L = Track soffit ht (T) + 55mm measured from FINISHED FLOOR	Door Panel Width = 0.5W + 20mm	Door Panel Ht = Track soffit ht (T) - 40 - 10(Floor gap)
1600		3150			
1800		3550			
2000		3950			
2200		4350			
2400		4750			

LEGEND :-

S.O. - Structural wall opening width.
W - Clear door width.

T - Height from Finish Floor Level (FFL) to Track soffit.
L - Height from Finish Floor Level (FFL) to Lintel soffit.
H - Height from Finish Floor Level (FFL) to Pelmet soffit.

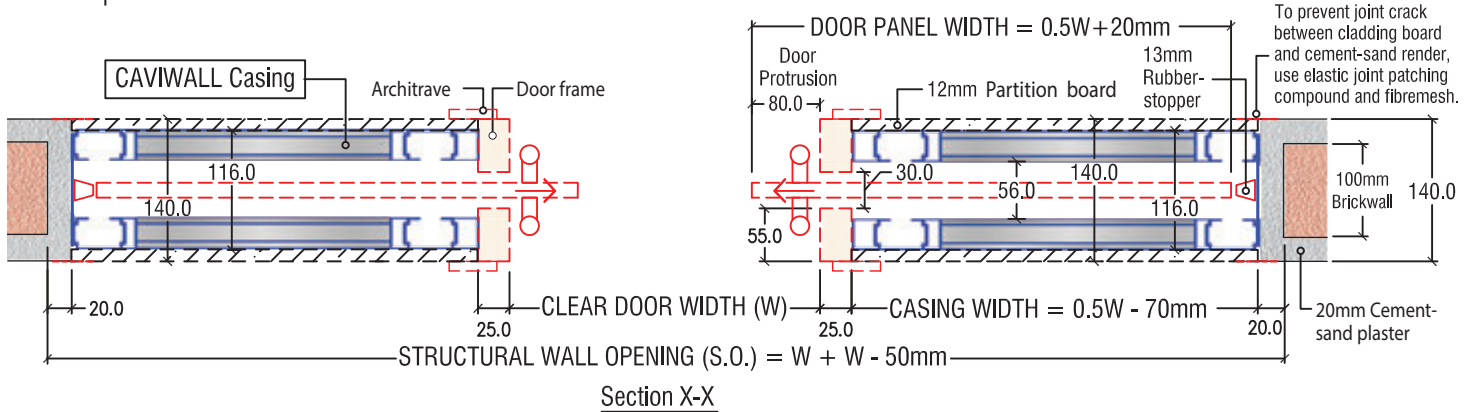
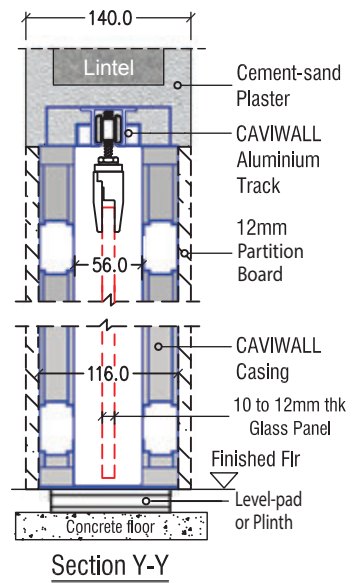
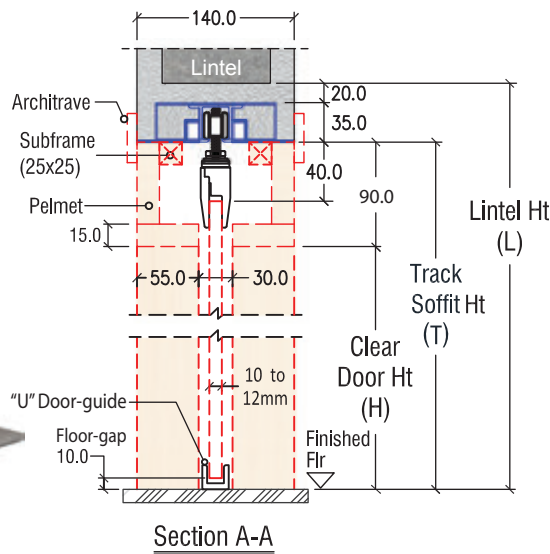
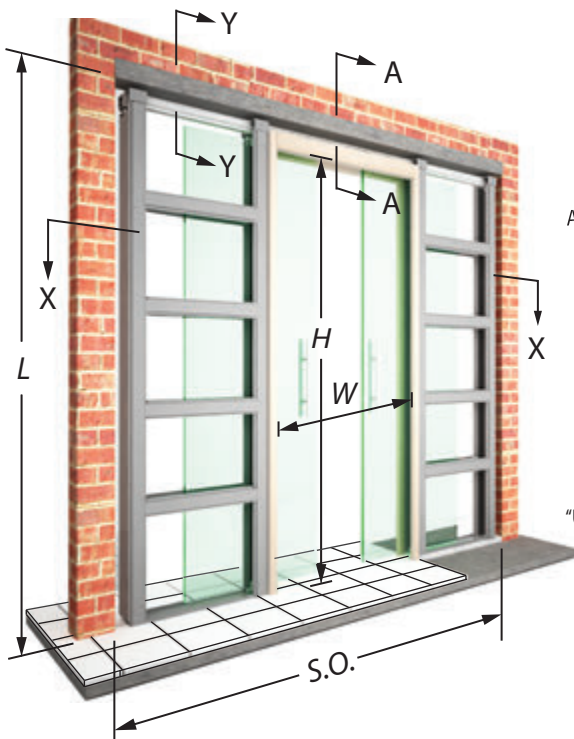

MATERIAL DESCRIPTION AND SPECIFICATION

Provide proprietary "CAVIWALL" cavity wall system for clear door opening W x H, comprising a factory pre-fabricated steel casing formed from connecting profiled steel studs, self-supported min 35mm Aluminium Track/s c/w side supports, upto 120kg capacity Rollers, Glass door aluminium clamps and sliding door accessories. Rollers must passed the 100,000 cycles Endurance Test by a government accredited testing center.

STANDARD ACCESSORIES



SLIDE & HIDE System (Suzhou) Co Ltd

Tel : +86-512-6593 0005
Fax : +86-512-6593 0006
Email : enquiry@slidehide.com.sg
Website : www.slidehide.com.sg

SLIDE & HIDE System (Singapore) Pte Ltd

Tel : +65-6369 9988
Fax : +65-6369 9977
Email : enquiry@slidehide.com.sg
Website : www.slidehide.com.sg

CAVIWALL SPECIFICATION



2D1B (2 DOORS in 1 BOX)					
CLEAR DOOR WIDTH, W (mm)	CLEAR DOOR HT, H (mm)	STRUCT OPENING S.O. (mm)	LINTEL HT, L (mm)	DOOR PANEL	
				WIDTH (mm)	HEIGHT (mm)
1400	H = 1900 to 3000mm in increment of 50mm	2250	+ L = Track soffit ht (T) + 55mm measured from FINISHED FLOOR	Door Panel Width = 0.5W + 60mm	Door Panel Ht = Track soffit ht (T) - 25 - 10 (Floor gap)
1600		2550			
1800		2850			
2000		3150			
2200		3450			
2400		3750			

LEGEND :-

S.O. - Structural wall opening width.
W - Clear door width.

T - Height from Finish Floor Level (FFL) to Track soffit.
L - Height from Finish Floor Level (FFL) to Lintel soffit.
H - Height from Finish Floor Level (FFL) to top door frame soffit.

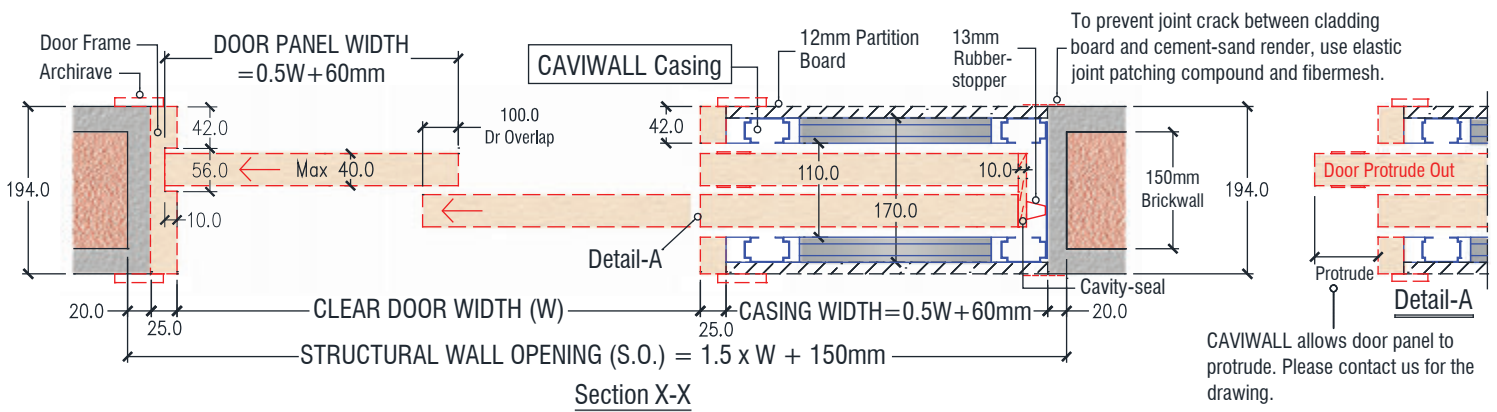
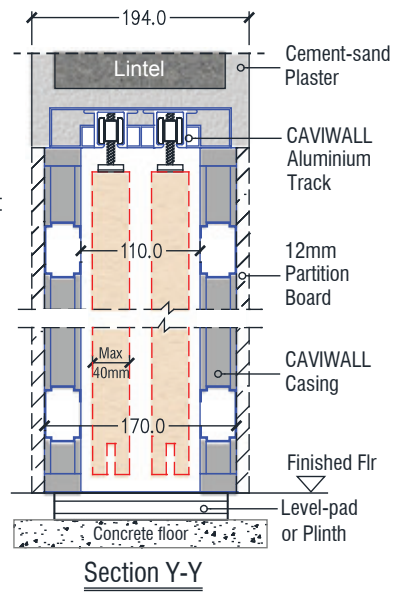
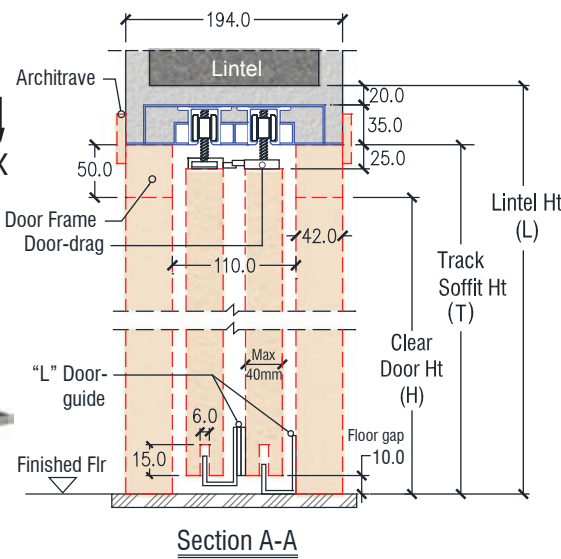
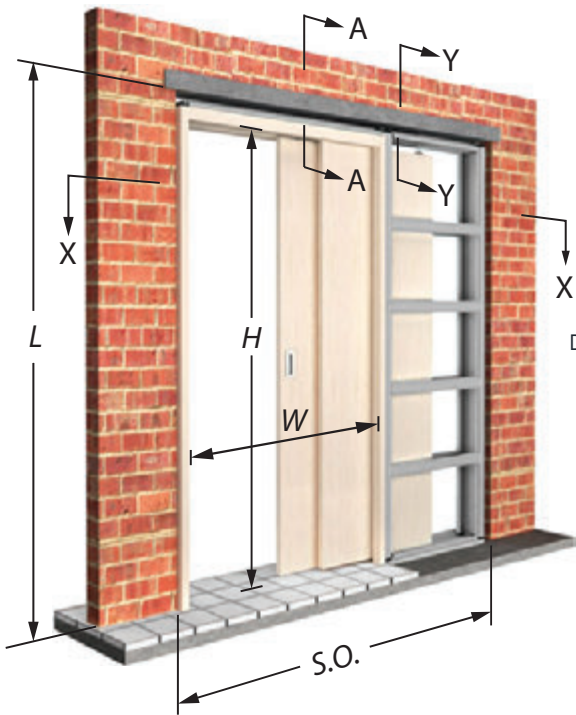

MATERIAL DESCRIPTION AND SPECIFICATION

Provide proprietary "CAVIWALL" cavity wall system for clear door opening W x H, comprising a factory pre-fabricated steel casing formed from connecting profiled steel studs, self-supported min 35mm Aluminium Track/s c/w side supports, upto 120kg capacity Rollers and sliding door accessories. Rollers must passed the 100,000 cycles Endurance Test by a government accredited testing center.

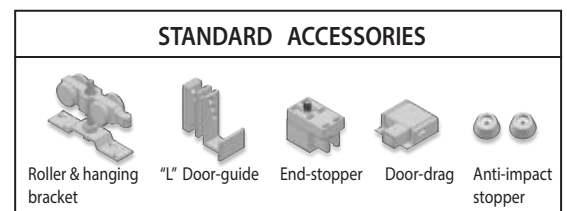

SLIDE & HIDE System (Suzhou) Co Ltd
Tel : +86-512-6593 0005
Fax : +86-512-6593 0006
Email : enquiry@slidehide.com.sg
Website : www.slidehide.com.sg

SLIDE & HIDE System (Singapore) Pte Ltd
Tel : +65-6369 9988
Fax : +65-6369 9977
Email : enquiry@slidehide.com.sg
Website : www.slidehide.com.sg

CAVIWALL SPECIFICATION



4D2B (4 DOORS in 2 BOX)					
CLEAR DOOR WIDTH, W (mm)	CLEAR DOOR HT, H (mm)	STRUCT OPENING S.O. (mm)	LINTEL HT, L (mm)	DOOR PANEL	
				WIDTH (mm)	HEIGHT (mm)
2400	H = 1900 to 3000mm in increment of 50mm	3810	L = Track soffit ht (T) + 55mm measured from FINISHED FLOOR	Door Panel Width = 0.25W + 60mm	Door Panel Ht = Track soffit ht (T) - 25 - 10(Floor gap)
2800		4410			
3200		5010			
3600		5610			
4000		6210			
4400		6810			

LEGEND :-

S.O. - Structural wall opening width.
W - Clear door width.

T - Height from Finish Floor Level (FFL) to Track soffit.
L - Height from Finish Floor Level (FFL) to Lintel soffit.
H - Height from Finish Floor Level (FFL) to top door frame soffit.

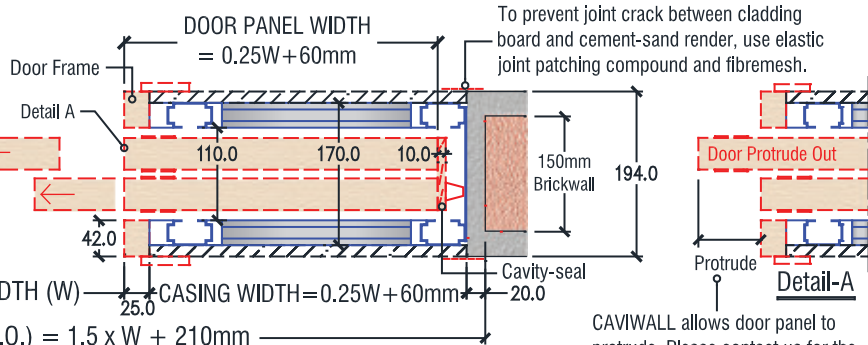
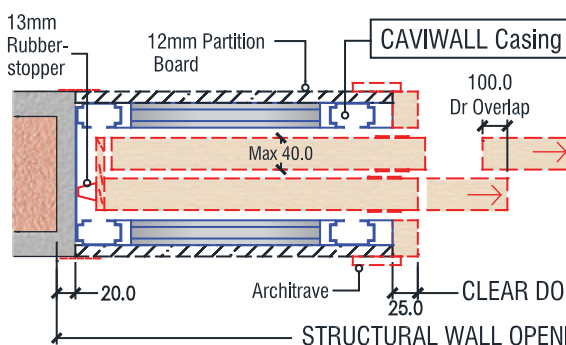
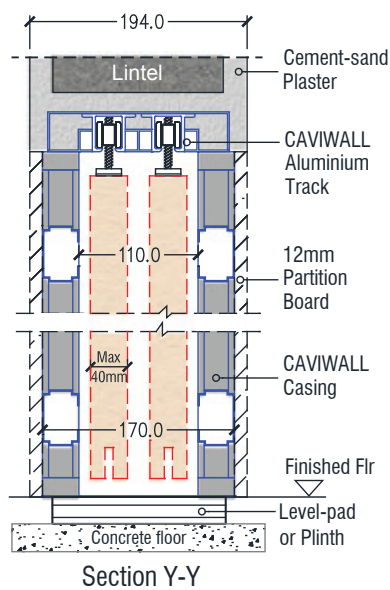
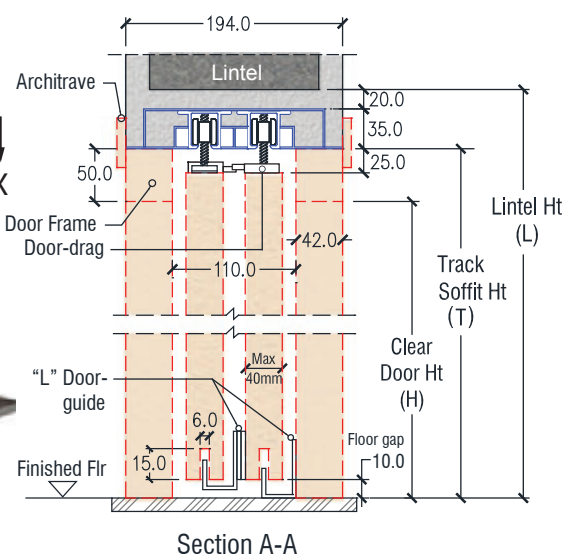
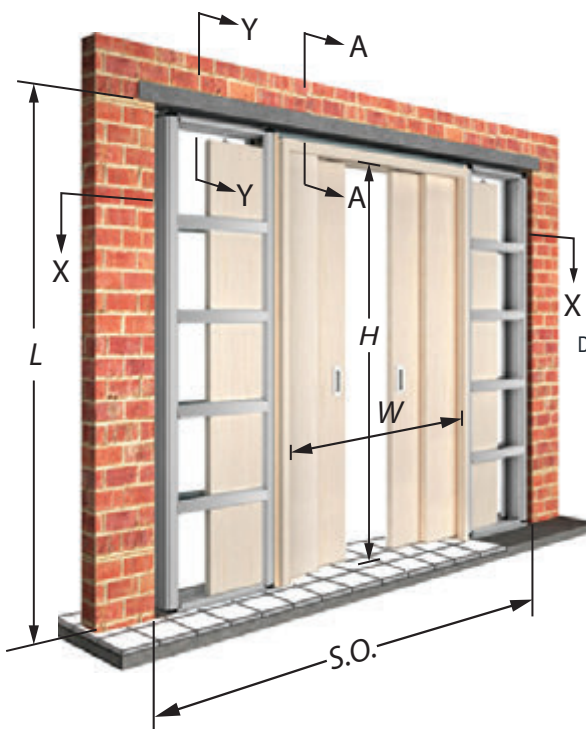

Section X-X

Detail-A

CAVIWALL allows door panel to protrude. Please contact us for the drawing.

MATERIAL DESCRIPTION AND SPECIFICATION

Provide proprietary "CAVIWALL" cavity wall system for clear door opening W x H, comprising a factory pre-fabricated steel casing formed from connecting profiled steel studs, self-supported min 35mm Aluminium Track/s c/w side supports, upto 120kg capacity Rollers and sliding door accessories. Rollers must passed the 100,000 cycles Endurance Test by a government accredited testing center.

STANDARD ACCESSORIES

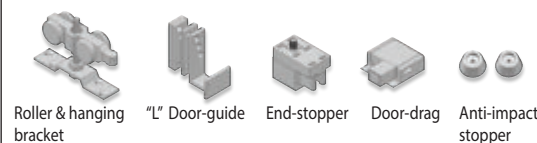

SLIDE & HIDE System (Suzhou) Co Ltd

Tel : +86-512-6593 0005
Fax : +86-512-6593 0006
Email : enquiry@slidehide.com.sg
Website : www.slidehide.com.sg

SLIDE & HIDE System (Singapore) Pte Ltd

Tel : +65-6369 9988
Fax : +65-6369 9977
Email : enquiry@slidehide.com.sg
Website : www.slidehide.com.sg

SLIDEHIDE Round Lockset (SHLK-R)

Specification:

Supply SLIDEHIDE lockset model SHLK-R for door panel thk 36 to 50mm. Lockset features include 1) hook striking action activated by safety push button 2) colour indicator to show lockset locking and unlocking status 3) thin (less than 1.8mm protrusion) cover plate against door panel surface 4) coin-open emergency unlocking function 5) no exposed lockset screw heads 6) striking plate hole size is adjustable.

Available finishes



Chrome(Cr)



Satin Silver(SS)



Finger pull handle

Safety push button

Hook
(activated by safety push button)



Strike plate

Green (unlocked)
Red (locked)

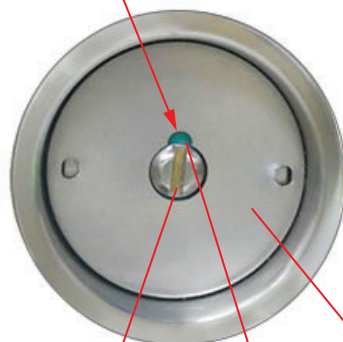

1

Striking plate hole size can be adjusted anytime to secure the hook.

2

Coin-open for emergency unlocking.

3

Locked & unlocked indicator.

4

No ugly screw heads.

5

Very thin cover plate to prevent hitting door frame incase door gap is small (eg. pocket door applications)

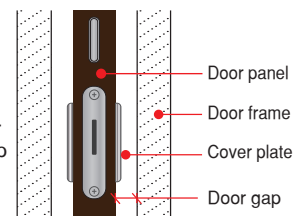

Door panel
Door frame
Cover plate
Door gap

POCKET DOOR LOCKSET DATA SHEET			
Lockset Name	Model	Door thk (mm)	Finish
SLIDEHIDE Round Lockset	SHLK-R	36 to 50	Chrome(Cr)
			Satin Silver(SS)

SLIDEHIDE Magnetic Lockset (SHLK-M)

Specification:

Supply SLIDEHIDE lockset model SHLK-M for door panel thk 36 to 40mm. Lockset features include 1) hook striking action activated only by magnet 2) colour indicator to show lockset locking and unlocking status 3) thin (less than 1.5mm protrusion) cover plate against door panel surface 4) pinhole emergency unlocking function 5) striking plate hole size is adjustable.

How does Lockset hook works?

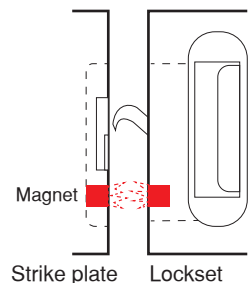

"When the Lockset is near to the strike plate, the magnet will activate the hook."

Magnet

Strike plate

Lockset

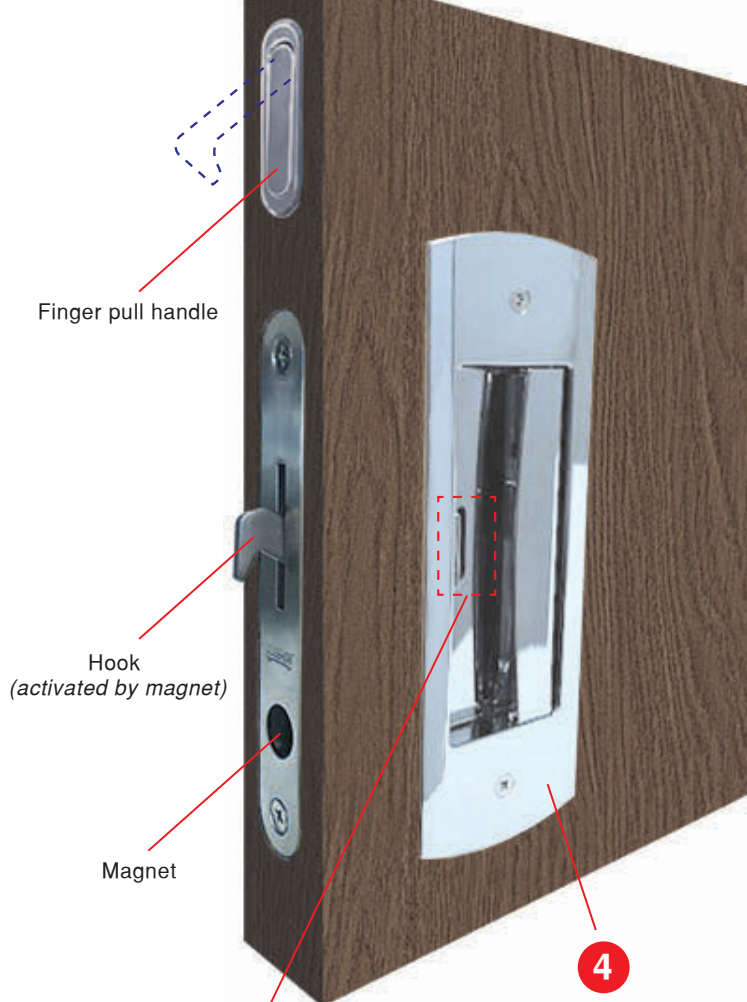

Finger pull handle

Hook (activated by magnet)

Magnet

4

Very thin cover plate to prevent hitting door frame incase door gap is small (eg. pocket door applications)

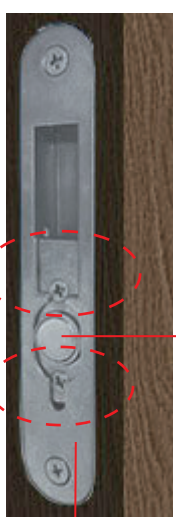

Strike plate

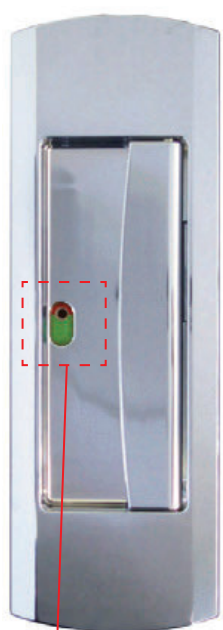

Chrome(Cr)

2

Pinhole button for emergency unlocking.

(Unlocked) (Locked)



3

Locked & unlocked indicator.

(Locked) (Unlocked)

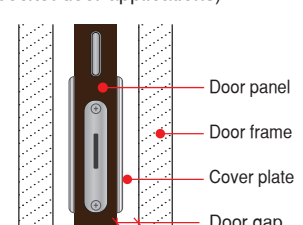

Door panel

Door frame

Cover plate

Door gap

1

Striking plate hole can be adjusted anytime to secure the hook.

POCKET DOOR LOCKSET DATA SHEET

Lockset Name	Model	Door thk (mm)	Finish
SLIDEHIDE Magnetic Lockset	SHLK-M	36 to 40	Chrome(Cr)

SLIDE & HIDE System (Singapore) Pte Ltd



About Door panel...

- 1) What is the maximum door panel weight that the Rollers can withstand ?
- *CAVIWALL rollers can hang up to 120kg door.*
- 2) What is the maximum door width limitation ?
- *The limitation for the door panel width is 1200mm .*
- 3) What is the maximum door thickness allowed ?
- *40mm is the max allowed, including door beading. Please check with us if door panel is going to be thicker than 40mm.*
- 4) Is there a limitation with regards to door panel design and material ?
- *There is no restriction. Anyone can select any design and material.*
- 5) Does the door panel wobble while it is sliding ?
- *There is a partially hidden door guide to control the sliding motion of the door panel. Hence, the wobbliness is not noticeable.*
- 6) Will the door panel get stuck inside the CAVIWALL casing ?
- *We have designed enough safe gap clearance and implement proper quality control in our manufacturing process to prevent this from happening.*
- 7) Do I have to hack the wall to change the door panel ?
- *No, just remove one of the top door frame will do. Refer to our catalogue for the procedure.*
- 8) We have experienced door panel sliding on its own caused by slanting track, due to bad workmanship or product quality. Will this defect also happen in CAVIWALL ?
- *Yes, the door panel will slide by itself if the track is slanting. This will not happen in CAVIWALL because our track is supported and controlled by the casing and due to our standardized production process, our casing accuracy is assured.*
- 9) Will there be a visible floor track on the floor ?
- *No, the floor finishes will not be disturbed.*
- 10) Can I adjust the floor gap between the door panel and the floor ?
- *Yes, the gap can be adjusted between 5 to 10mm.*
- 11) Do you supply and install the timber door frame and door panel ?
- *No we don't for the following reasons :-*
 - a) *We are not a door contractor.*
 - b) *The door panel and door frame design, workmanship and material used must be the same as the swing doors in other rooms.*
 - c) *There will be economy of scale and cost if all the timber doors and frames comes from the project door contractor.*
- 12) If the door panel and frame is supplied and installed by a 3rd party (door contractor), will there be accuracy problems ?
- *There will not be any problem. As CAVIWALL casing is produced by machines using systematic manufacturing processes, the casing dimensions are accurate. As such, when the door panel and frame is fixed onto the casing, it will also be accurate.*



About CAVIWALL casing...

- 13) Can I hang objects onto CAVIWALL finished wall surface ?
- *Yes, if the weight is below 15kg. For weight exceeding 15kg, please check with us.*
- 14) Will crawling insects and rodents reside inside the casing ?
- *Since the history of CAVIWALL, we have not heard of such incident happening.*
- 15) How long it takes to install a CAVIWALL casing ?
- *One skilled worker requires 30 to 45mins to install a CAVIWALL casing.*
- 16) Will there be water ponding inside the cavity base ?
- *If the casing base is on the same level as the floor finishes, ponding will not happen.*
- 17) At which construction stage will CAVIWALL need to be installed ?
- *Immediately after erection of brickwall and lintel.*



About CAVIWALL rollers...

- 18) What is the lifespan of CAVIWALL rollers ?
- *Under normal usage and within our design specification, more than 10 years is definitely no issue.*
- 19) Is CAVIWALL rollers noisy while the door panel slides ?
- *So far our customers are happy with the smoothness and quietness of CAVIWALL rollers.*



About CAVIWALL In General

- 20) Is customized clear door opening width possible, eg. 820mm ?
- *It can be done if the quantity exceed 100 sets for one size.*
- 21) What is the acoustic performance of CAVIWALL ?
- *So far the sound damping property is acceptable to our customers.*
- 22) Will the cavity wall vibrate when the door panel is sliding ?
- *No such problem for CAVIWALL.*
- 23) What is the warranty period ?
- *Our standard warranty period is ONE year.*

We apologise if you cannot find the answer to your questions... please email (enquiry@slidehide.com.sg) your questions to us and we will get back to you soonest possible.

SINGAPORE (HQ)

SLIDE & HIDE System (S) Pte Ltd

11, Yishun Industrial Street 1, #07-99, North Spring Bizhub. Singapore 768089

Tel: +65 6369 9988 **Fax:** +65 6369 9977

For Enquiry: enquiry@slidehide.com.sg

For Feedback: cust-svc@slidehide.com.sg

Website: www.slidehide.com.sg

Regional Offices :-

(CHINA)

SLIDE & HIDE System (Suzhou) Co., Ltd

Branches	Telephone	Fax
Suzhou	+86 512 6593 0005	+86 512 6593 0006
Shanghai	+86 21 6233 9866	+86 21 6233 7276
Shenzhen	+86 755 8363 3199	+86 755 8363 0068

(MALAYSIA)

SLIDE & HIDE Space Saving System (M) Sdn Bhd

Tel: +603 7887 8891 **Fax:** +603 7887 8896

(PHILIPPINES)

Wisdom and Wealth Trade, Inc. (Associate Co.)

Tel: +632 668 6698 / +632 507 2680

Fax: +632 277 7832



- No part of this catalogue may be reproduced or transmitted in any form or by any means, or stored in any retrieval system of any nature, without prior written permission from SLIDE & HIDE SYSTEM (SINGAPORE) PTE LTD.
- The technical presentation and data including illustrations and drawings are not binding. SLIDE & HIDE SYSTEM (SINGAPORE) PTE LTD reserves the right to make modifications/ additions/ alterations/ improvements when necessary without prior notification.
- Copyright 2015: SLIDE & HIDE SYSTEM (SINGAPORE) PTE LTD. All rights reserved.
- "CAVIWALL" & "SLIDEHIDE" are registered trademarks of SLIDE & HIDE SYSTEM (SINGAPORE) PTE LTD.
- The system in this catalogue is protected.

Distributed by :-

